

- Door is locked from the outside
- The door show a red color for lock
- When the user click on the unlock/lock button it will unlock the door

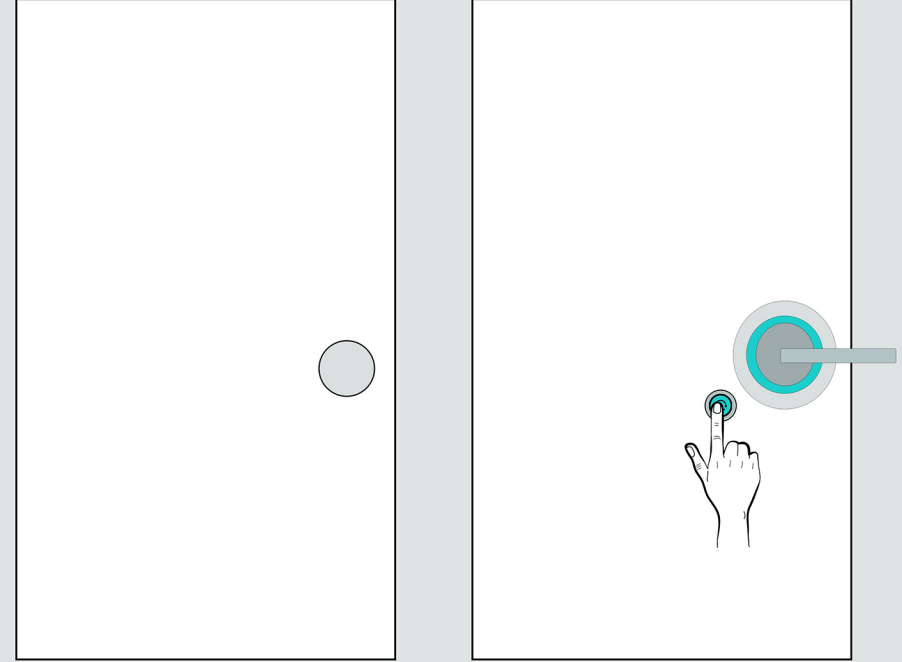

- Door is now unlocked
- The color changes from red to blue to show it is unlock.
- Outside panel is unaffected

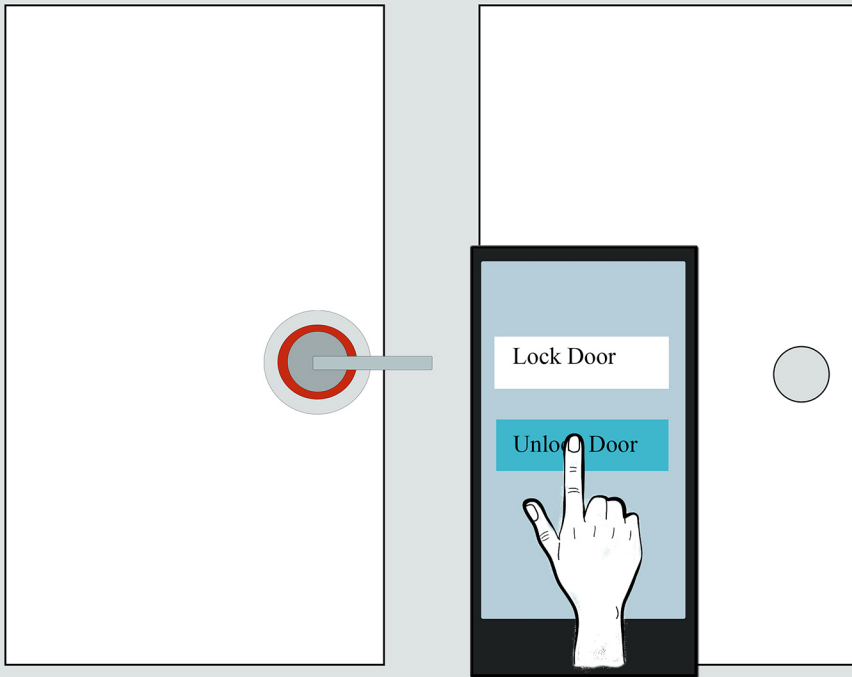

-When the user wants to unlock the door they can use their cell phone or key.

-By tapping unlock button their phone unlocks the door

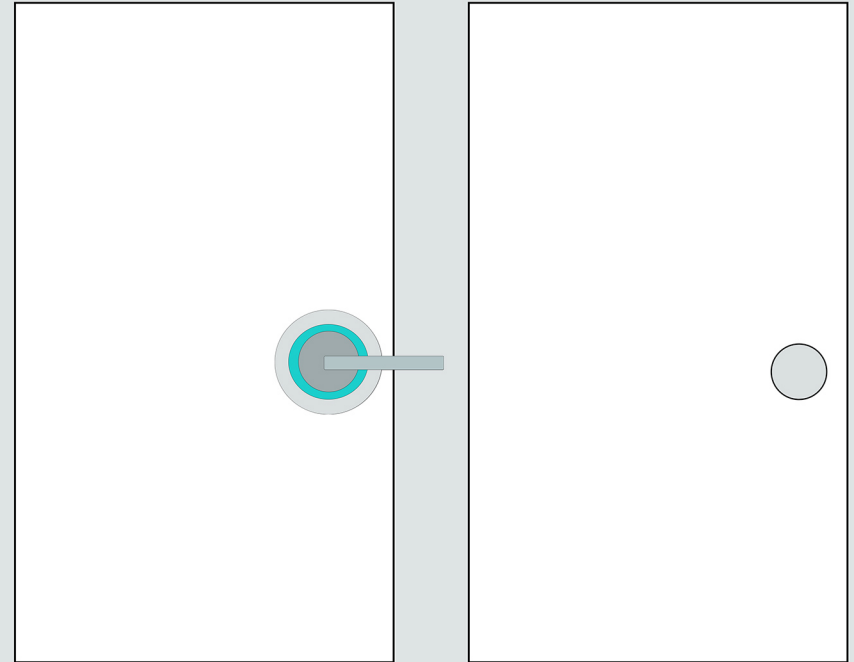

-The color of the inside of the door changes from red to blue.

-The users will get feedback from the phone that door has been unlock successfully.

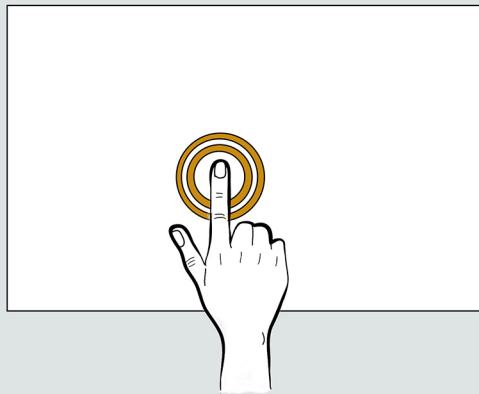

- When users the door initial they have blank door
- To lunch the naivagation bar they would have to tap on the door

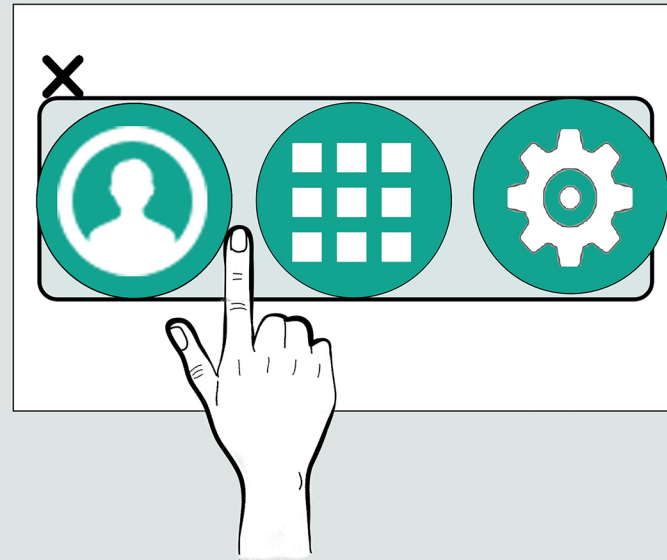
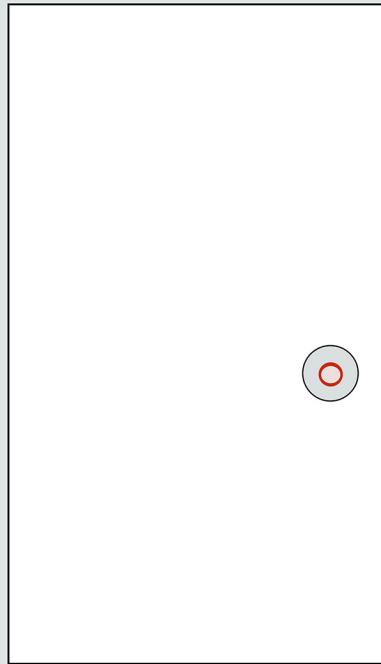

- When the users taps on the door the naivagation bar will pop based where they tap.
- The naivagation bar shows options for user profiles, apps , and settings.

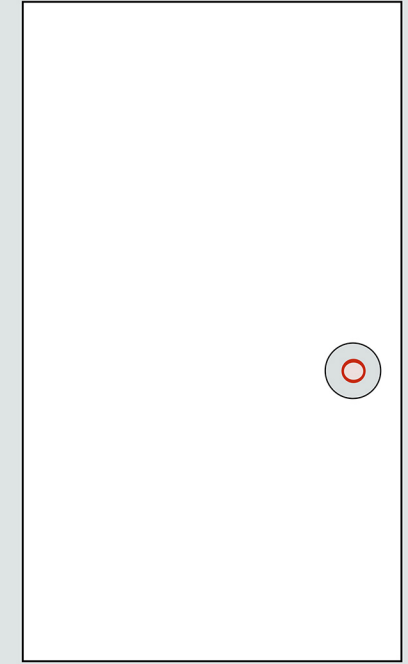

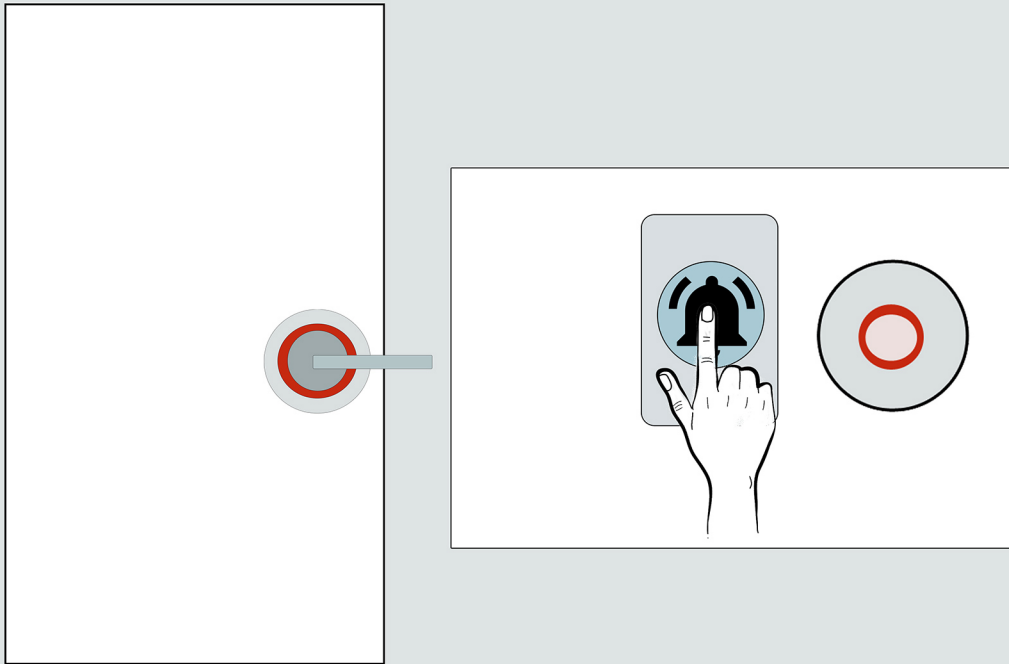

- Visitor is at the door and does not have a key
- Visistor rings door bell next to the door

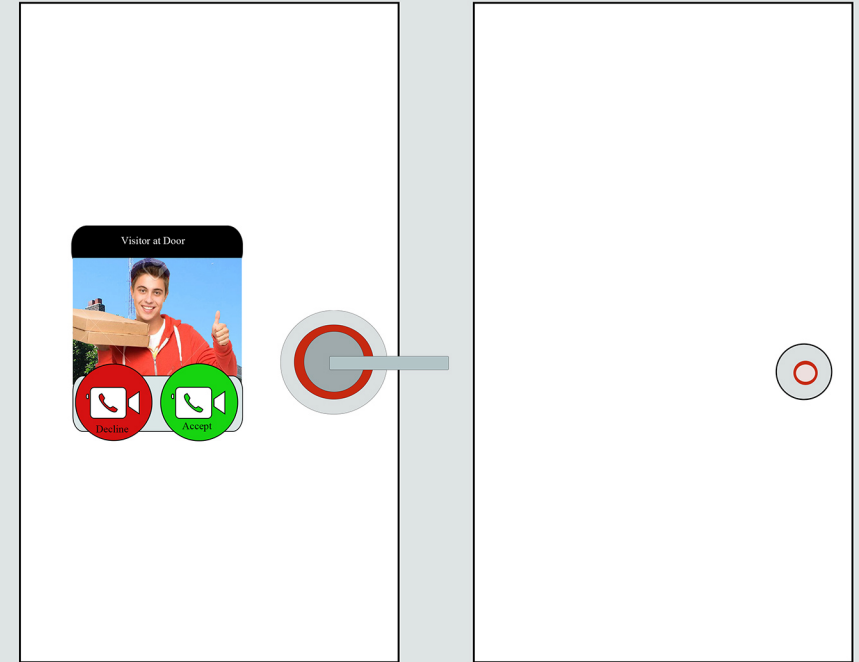

- Door bell is rung and makes a sound heard by the user
- It popup with a message showing the visitor the user can open the door or answer the video feed

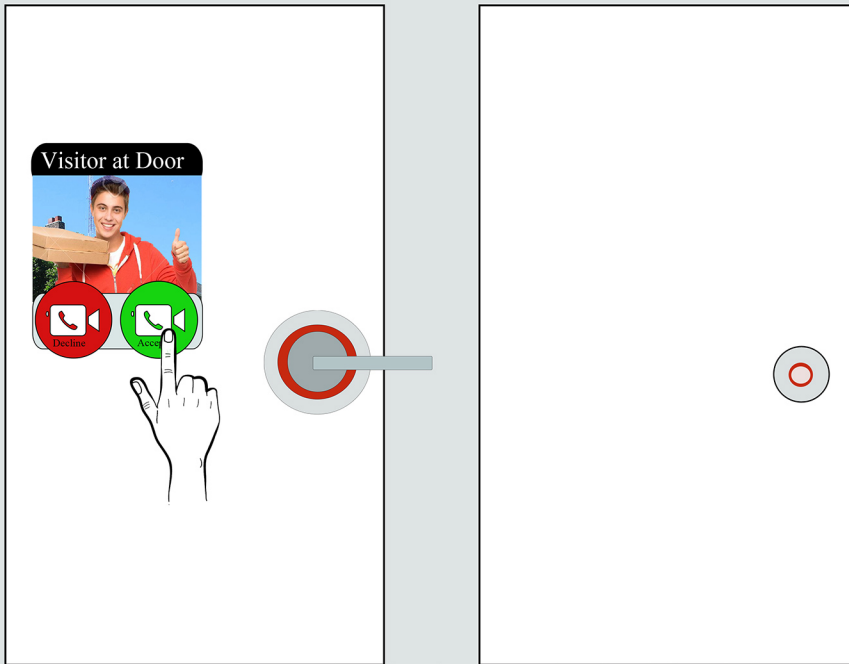

- A popup message is display on the inside if the user gets a visitor.
- The popup message gives the user the option to accept video or decline to see who on the other side.
- The popup will give the user information on the visitor



- When the user accepts the video chat popup message they are greeted with full screen video of the visitor.
- The user is given options to end the call, turn on the mic, or turn on the camera from their side.
- Nothing is displayed on the other side

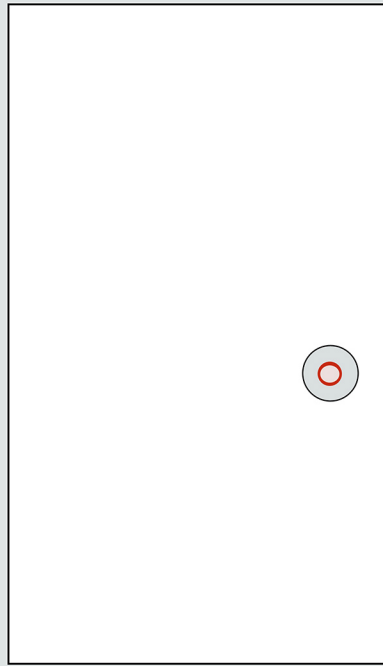

- User wants to open video feed on other side
- Initial state of button is green

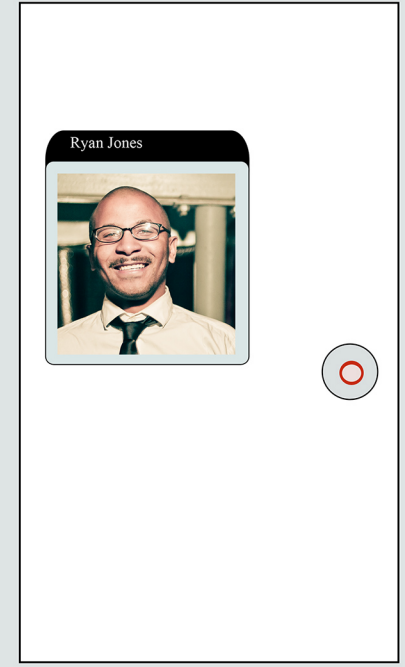
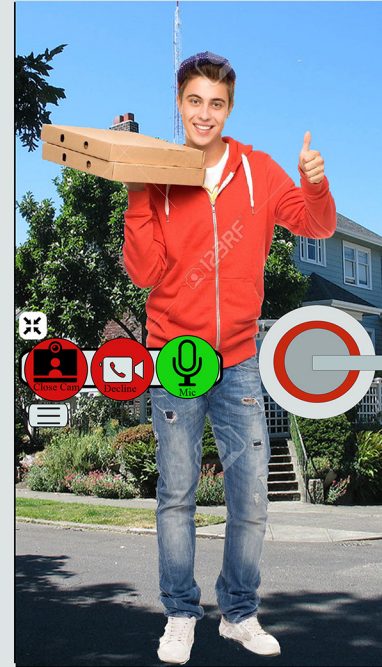

- Video feed is open on the side of the door for the visitor
- Color of the button changes to red to inform them that they close video feed.

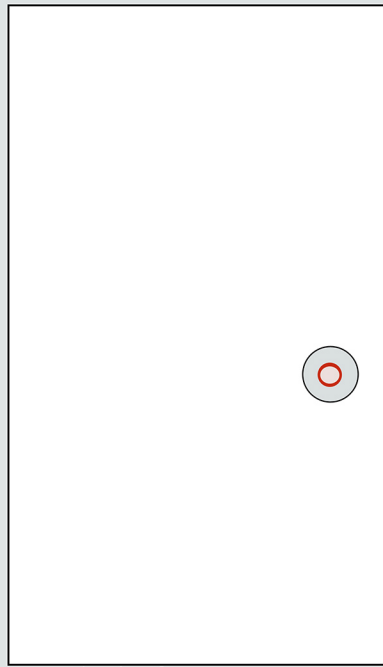
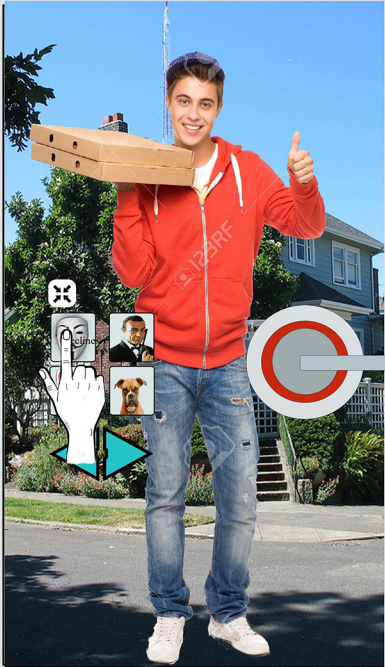

- User wants to display avatar on their face
- User is give several avatar to choose from and can cycle between them
- Clicking on the one of the avatar will diaplay an avator over their face.

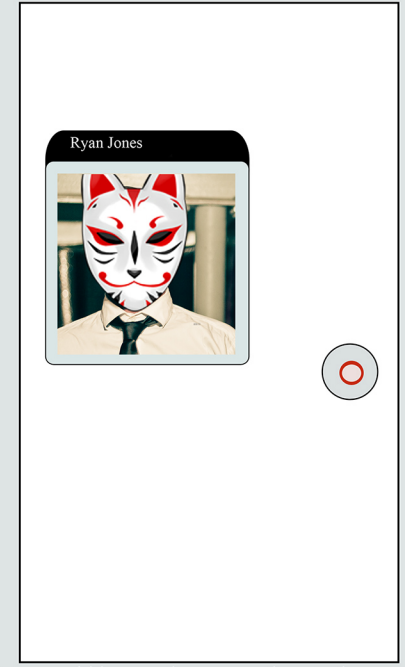
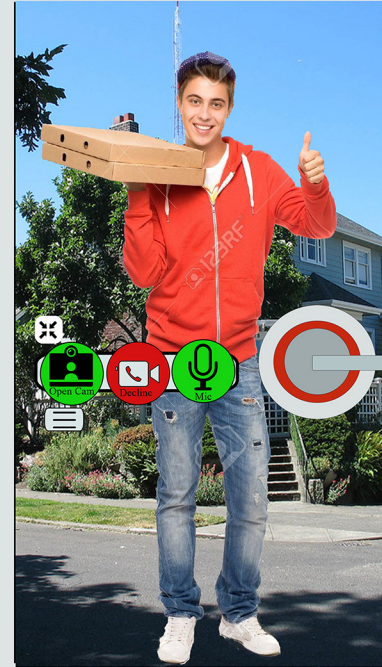

- Clicking on one of the avatar will replace what they look like on the other side.

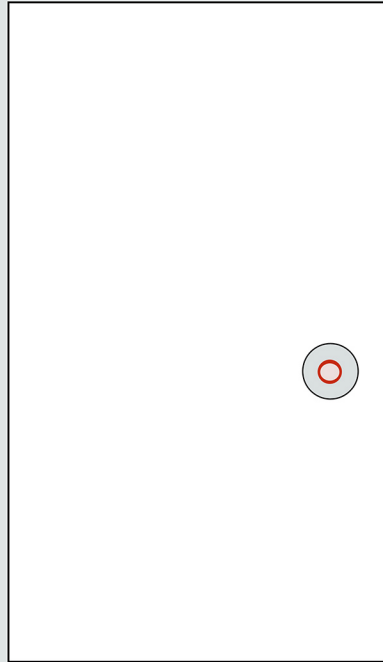
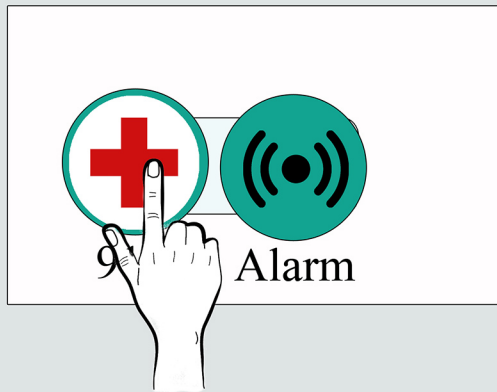

- This is a quick access menu
- It will be display on the door at all times so the user can quickly call 911 in emergancy or turn off the alarm..

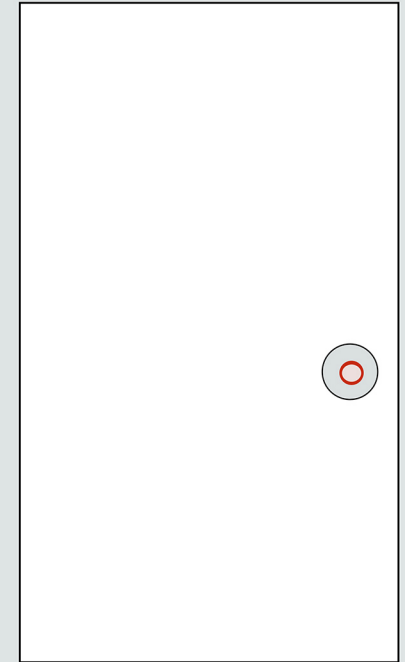
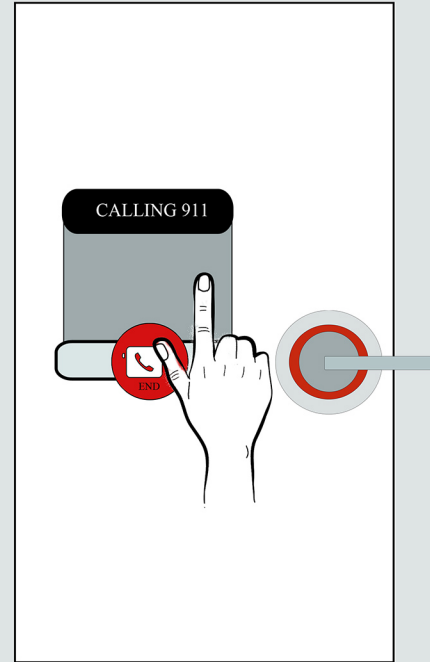

- When the user hit 911 button it start process of calling
- The user will be able end the call if hit by accident or contiune with the call for the police, medical assistance , or a fire truck.

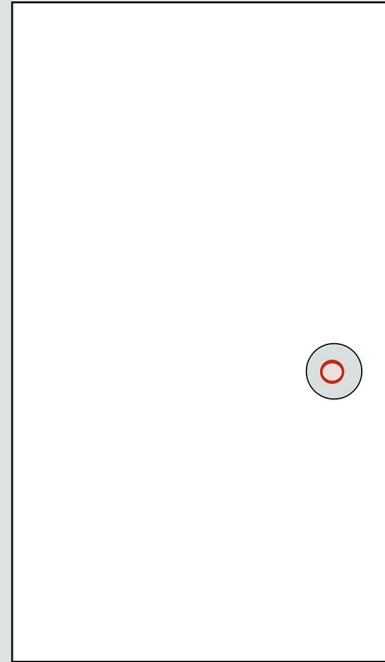

-By tapping on the app icon the user will get listing of different apps.

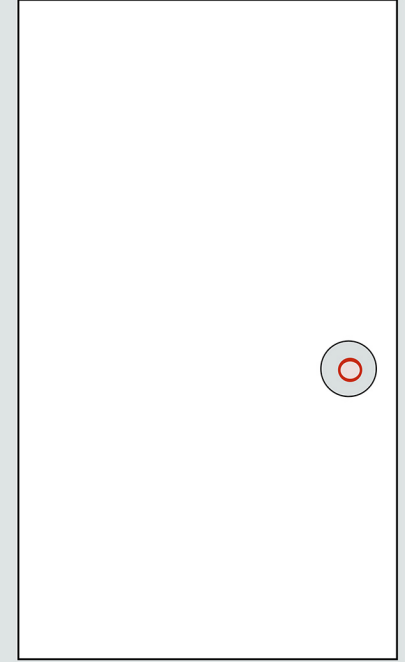
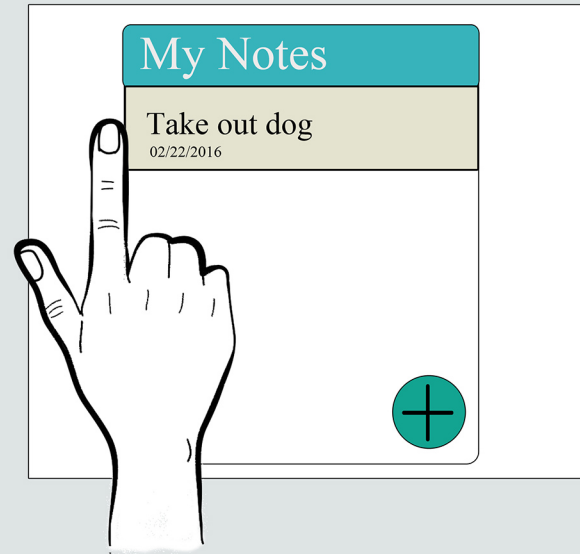

-Tapping on the Notes app will bring up the note application..
 -This is initial screen the users sees when lunching the app.
 -It shows current notes and ability to make new notes

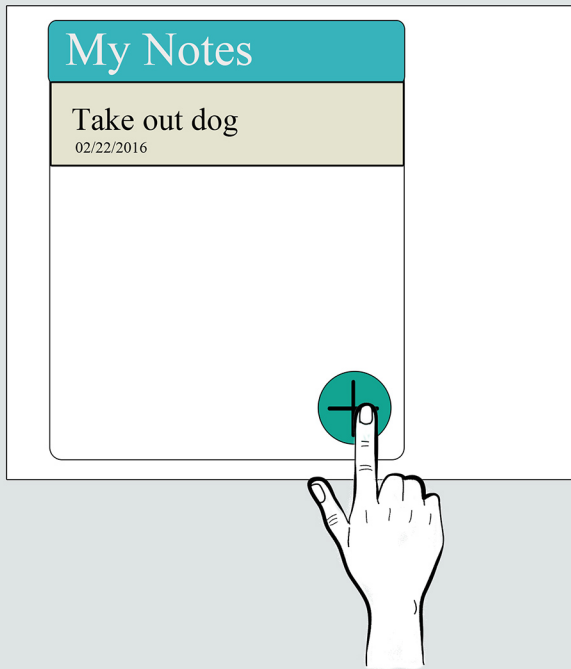

-User creates a new note

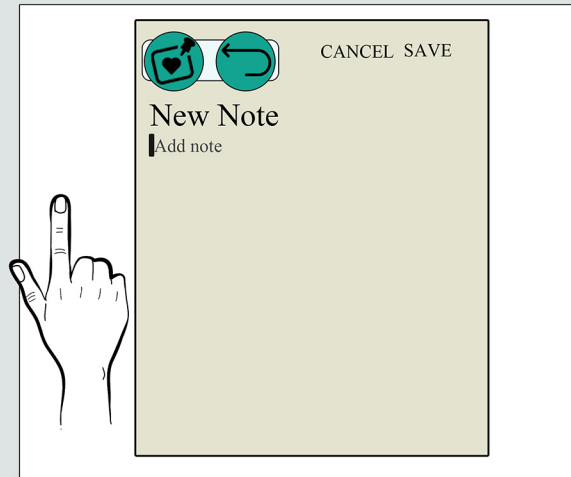
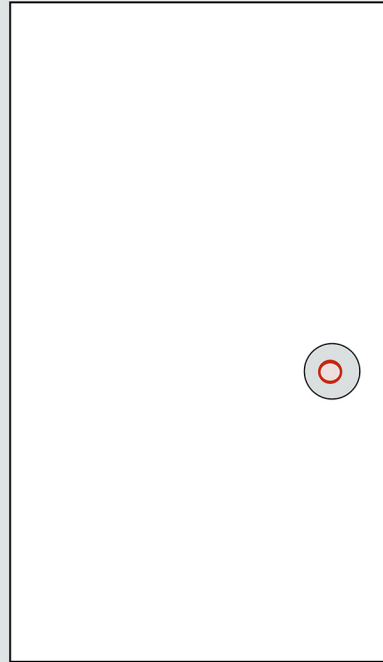

-A blank note is shown

-It shows option to post it , go back, cancel, or save the note

-User can type the note using app made for the phone or with the onscreen keyboard for the door

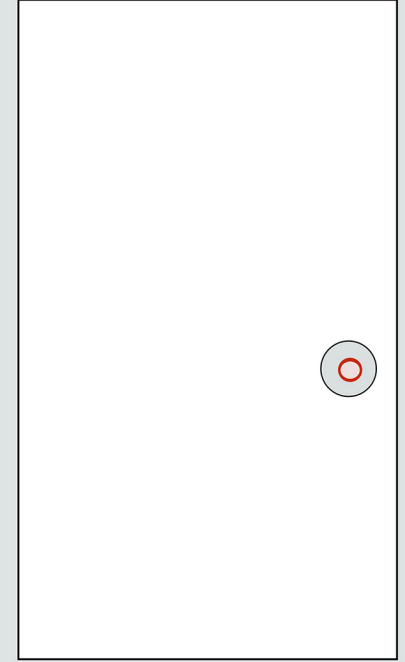

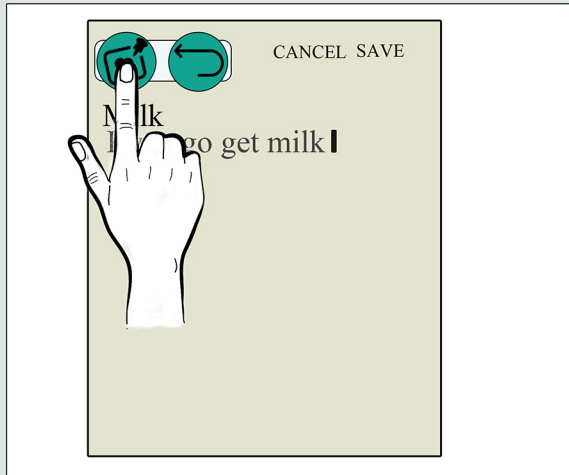

- The user taps the post it button
- User has finish writting a note and wants to post it on the door

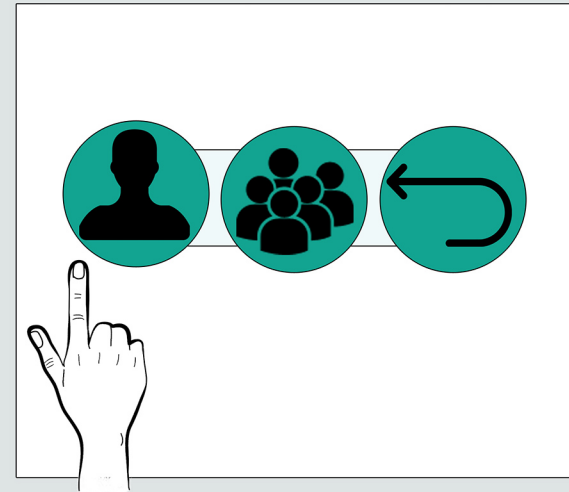
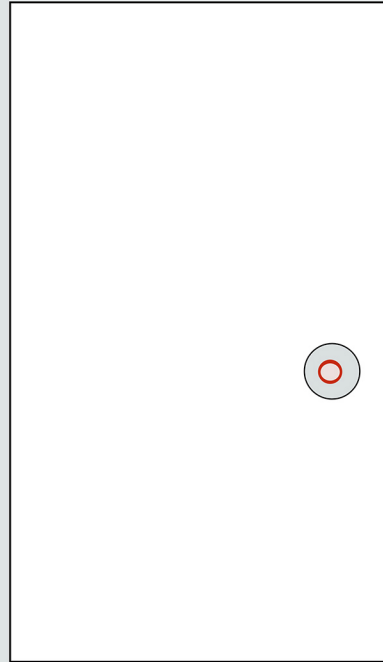

- The user is taken to menu with several options to post the note
- User can make into private note or public note

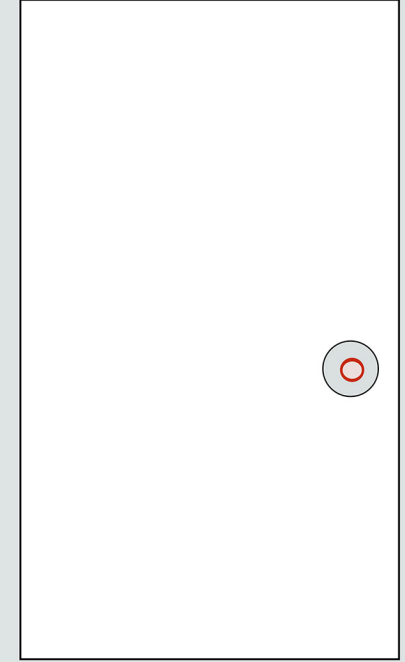

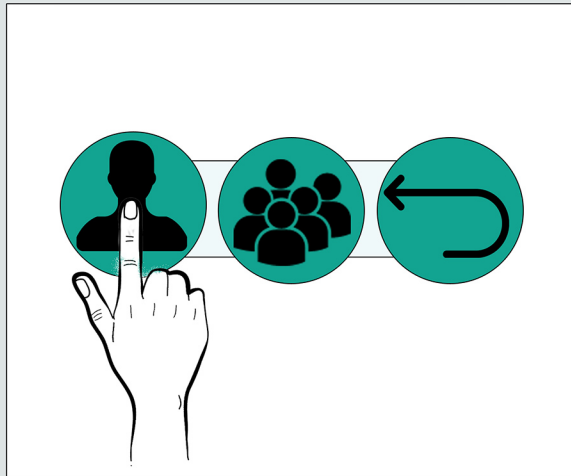

- User want to make the note private
- The user taps the private button

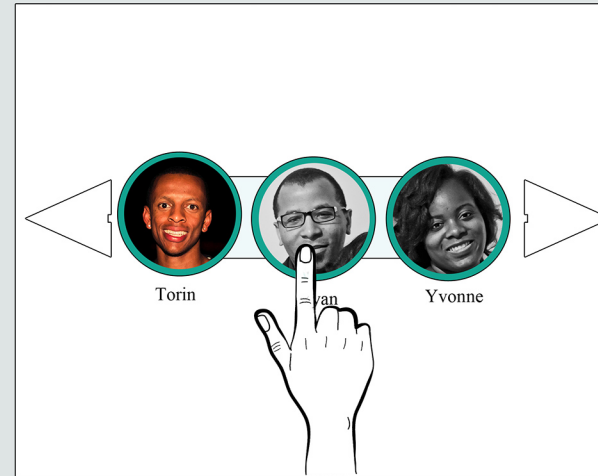
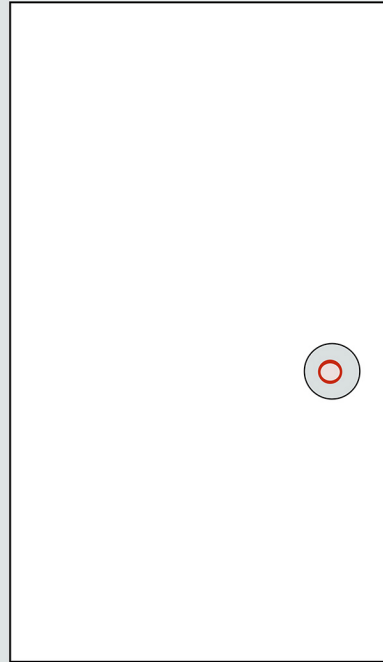

- User is shown contact profiles
- They can select person who they want to make the message private to

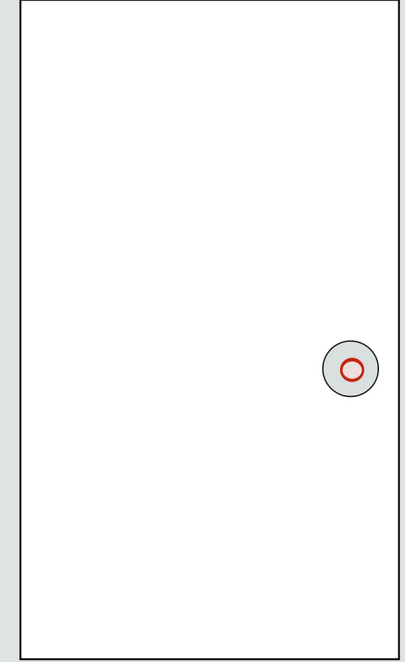

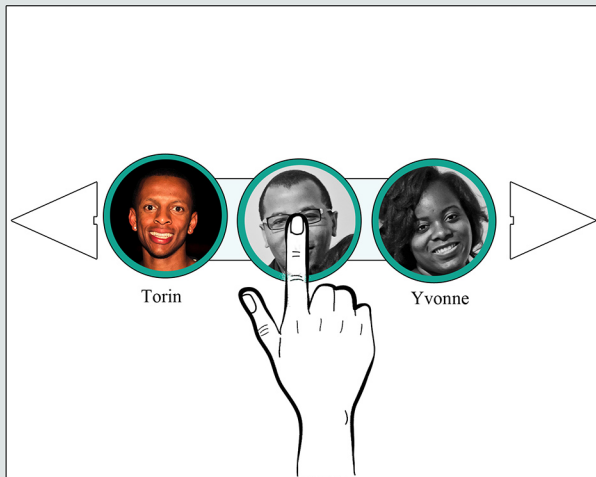

-User select the individual want to private message

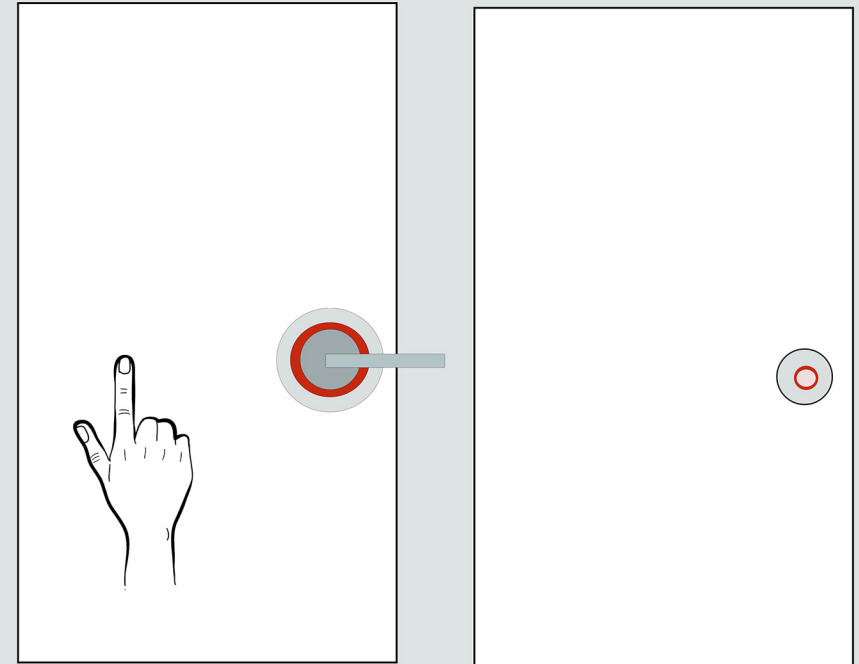
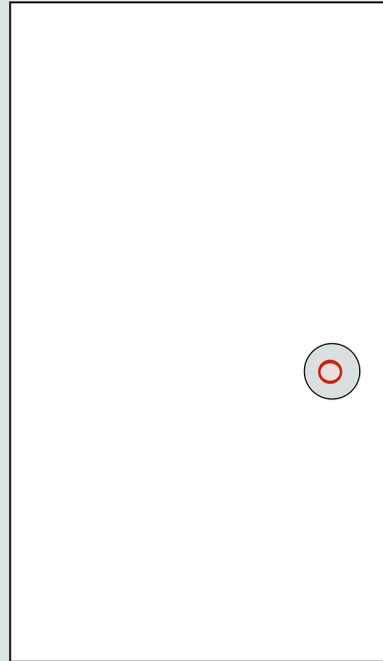

-Nothing is shown on the other side of the door until that user arrives at the door

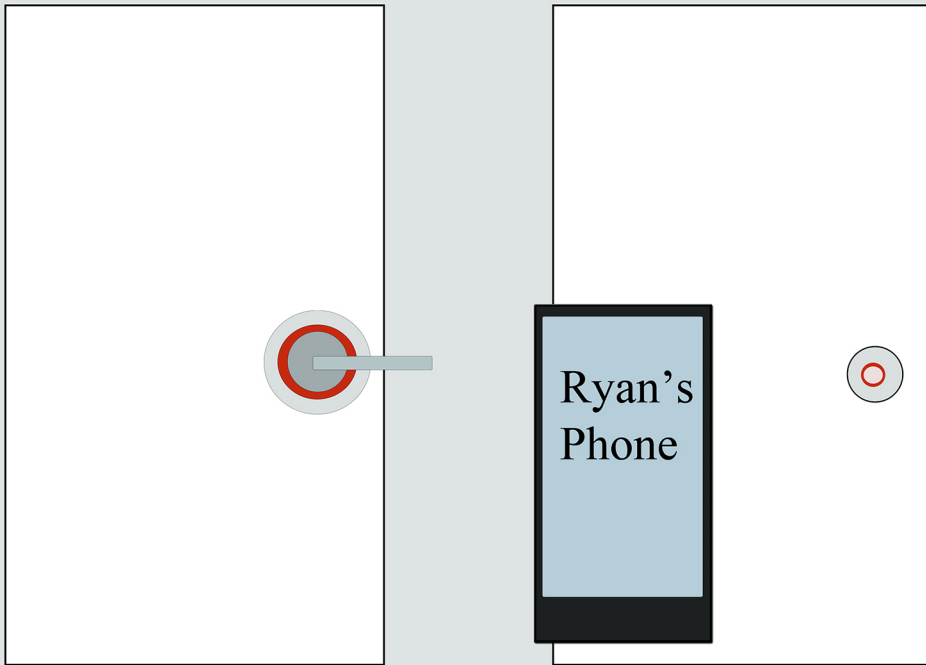

-When the user is outside or inside of the door it will recognize their phone

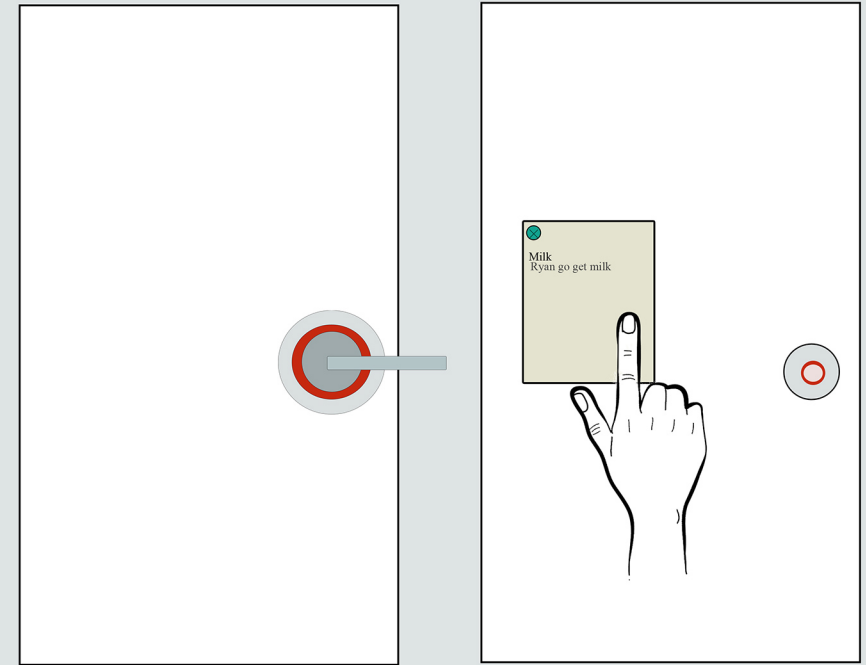

-The door will display the note for that user if it recognizes their phone.

-They can move it around, close or save it.

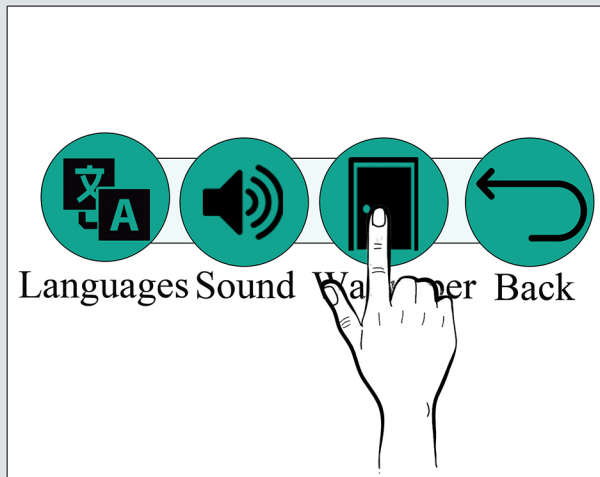

- User wants to change the wallpaper that is displayed on the door
- User clicks on the door icon

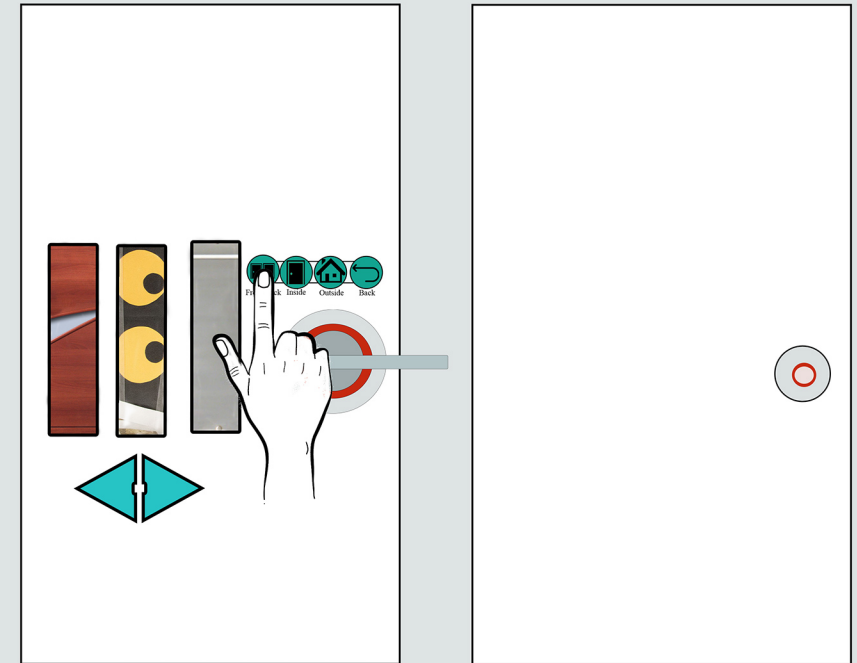
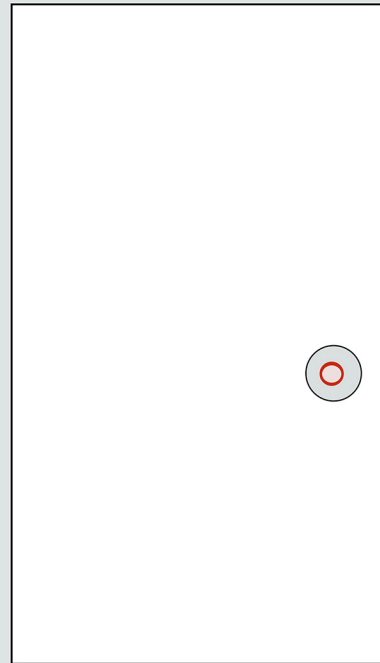

- Takes the user to the wallpaper display menu
- User choose do one side or both side of the door
- User can choose from the list of wallpapers to change to on the door.

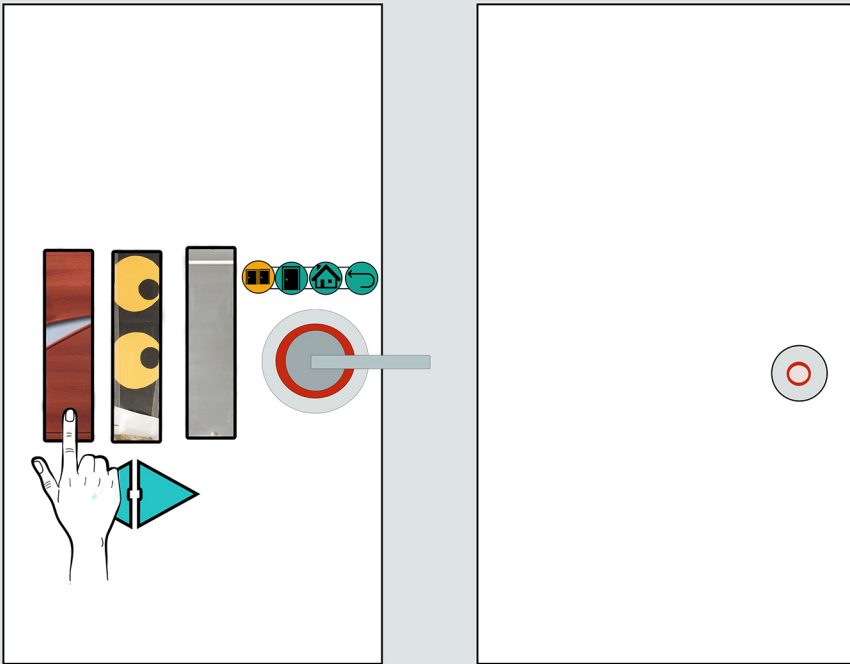

- By tapping on the double door icon the user can change the look of the door from both sides
- The user can cycle through a list of different looks and then tap on the one that they like



- When a user taps on a look they like it get applied to both sides of the door.

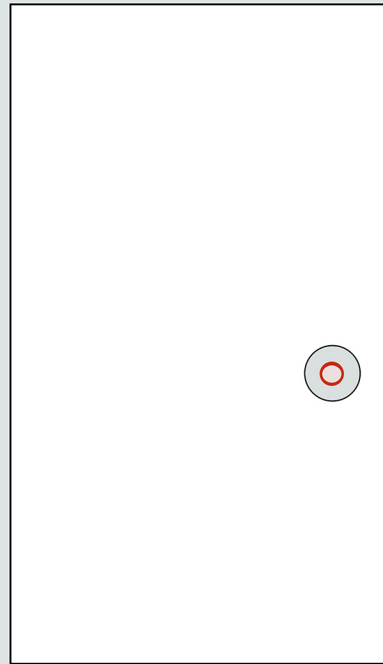
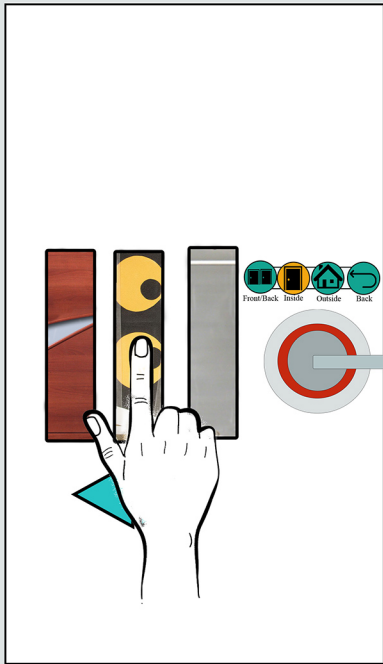

- User want to change the look of the inside of the door
- User can cycle through a list of door types

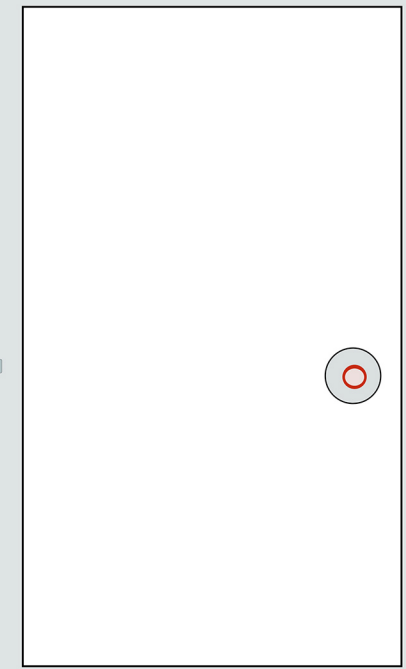

- User selects one and the inside look of the door changes
- The outside of the door remains unchanged

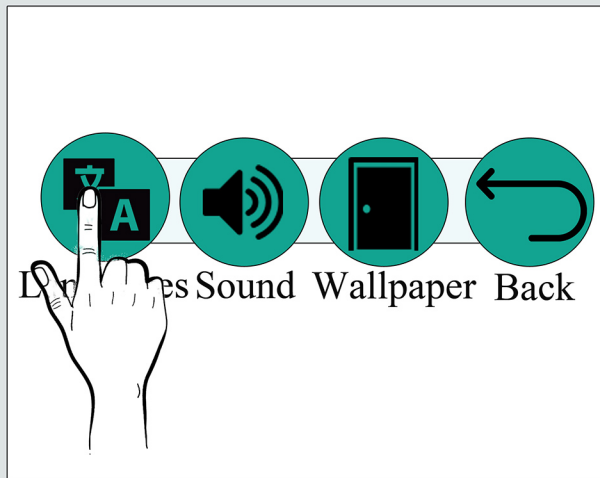

- User wants to change the languages
- User taps the language icon

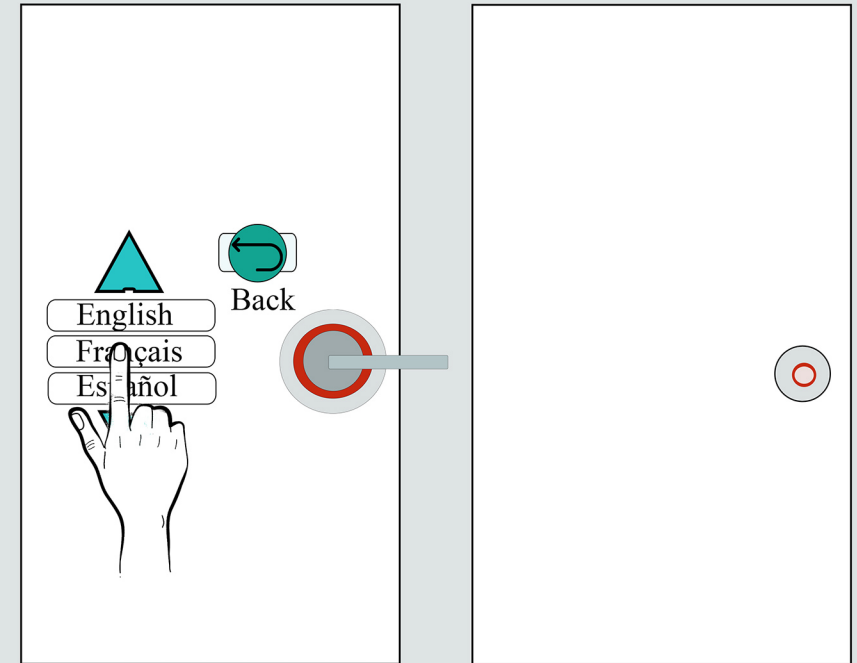
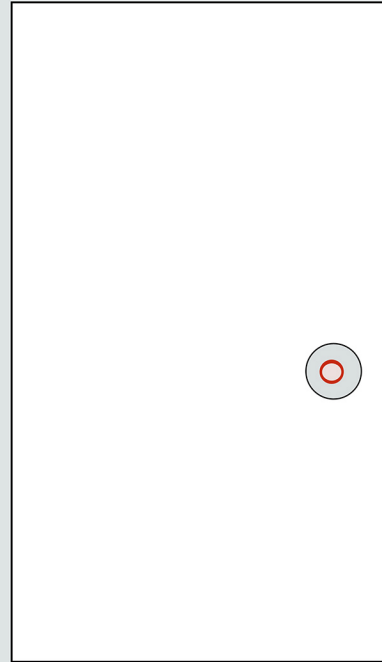

- User is given a list of languages to choose from
- User can cycle through the languages list by tapping the up or down buttons
- User can go back to the settings menu by tapping back button

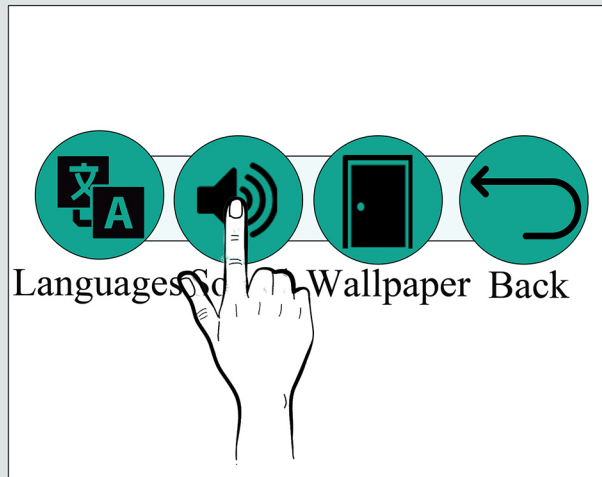

- User wants to go to the sound settings
- By tapping on the sound icon, the user is taken to the sound options

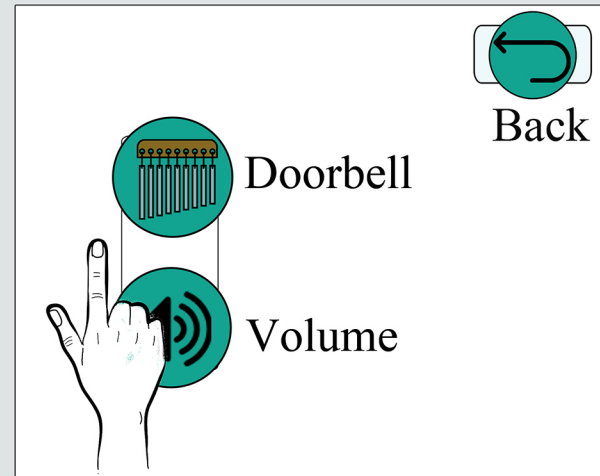
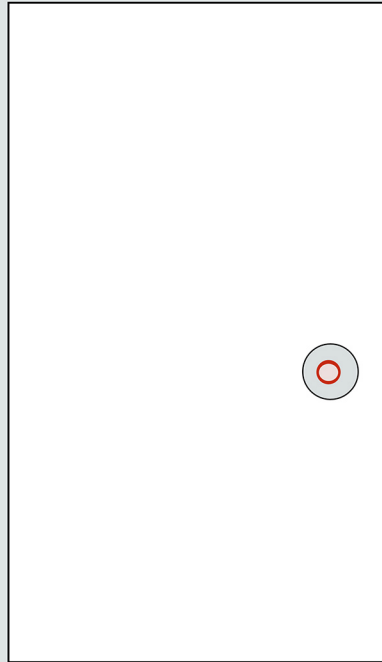

- The sound option is display on the door
- User can change the doorbell sound, change the volume, or go back to settings.

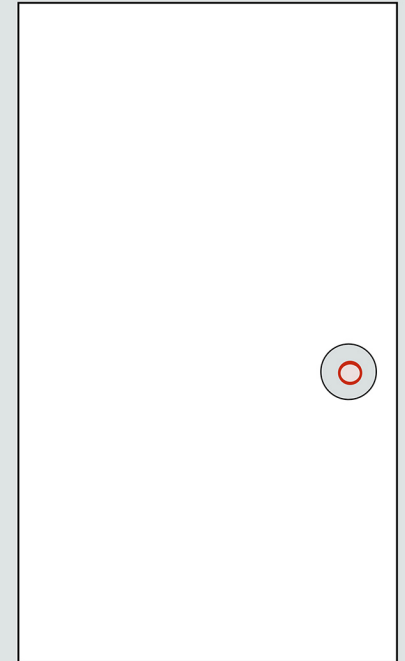

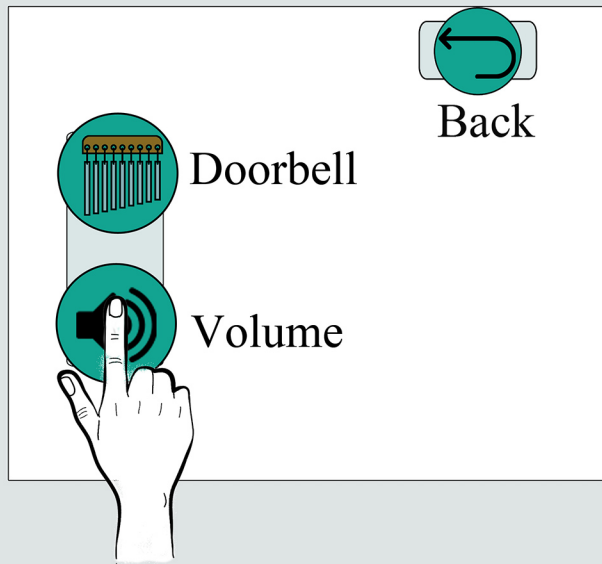

- User wants to change the volume
- User taps on the volume icon

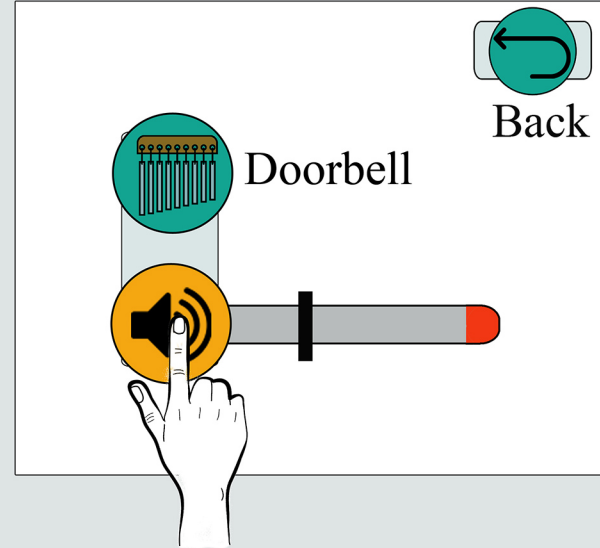
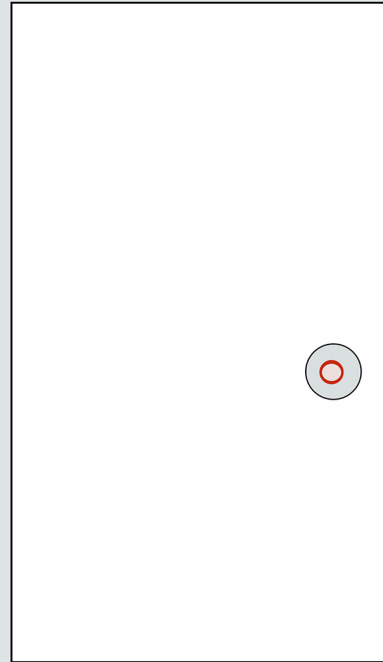

- The icon displays a bar to adjust the volume
- User can slide bar up or down to change the volume

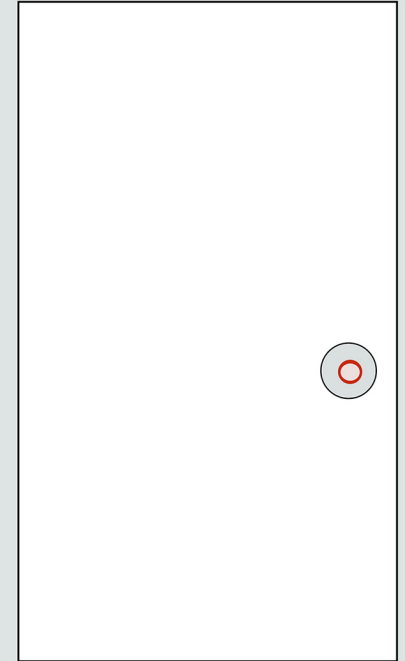

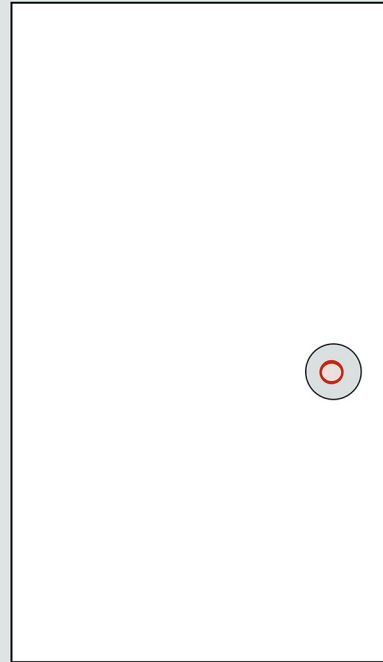
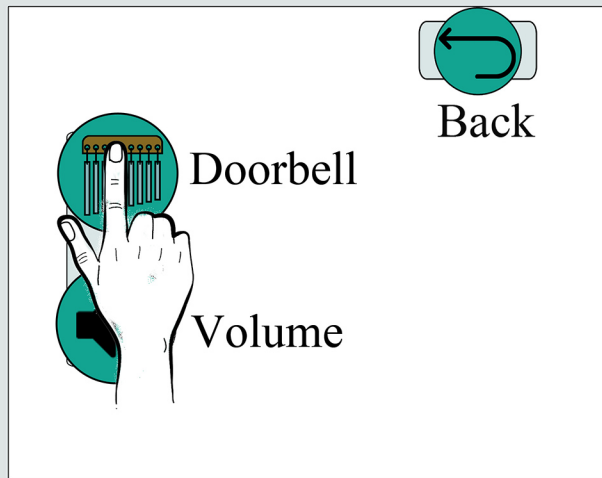

- User wants to change the sound of the door bell
- User taps the door bell icon

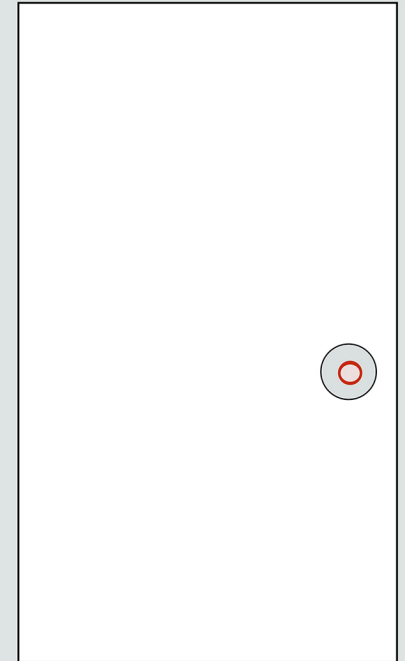
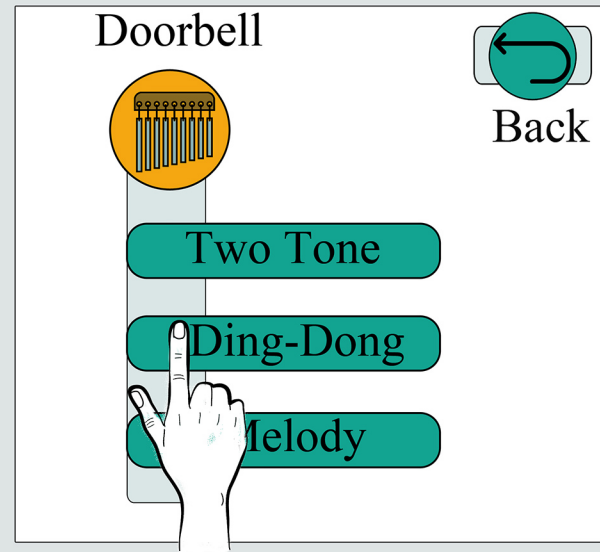

- User is given a list of door bell sounds
- User can tap on a sound to change the way doorbell sounds

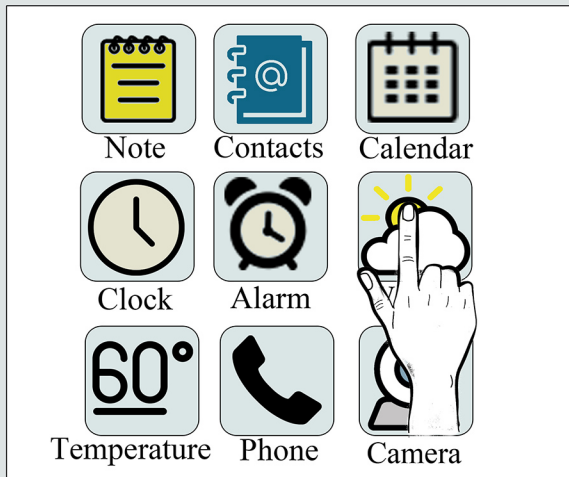

- User wants to access the weather app
- User taps on the weather app

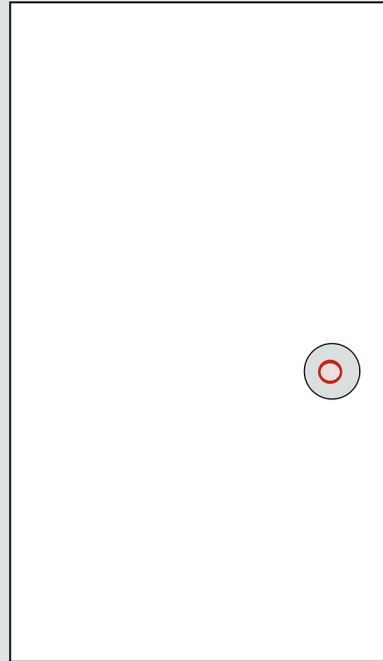

- The weather app show current added location, settings, and an ability to add another location
- This app can be moved around

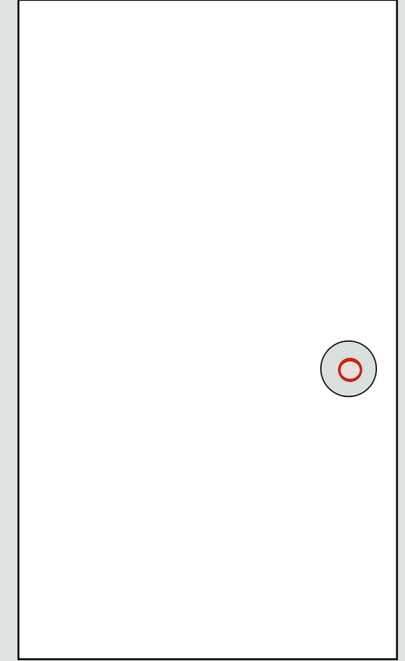

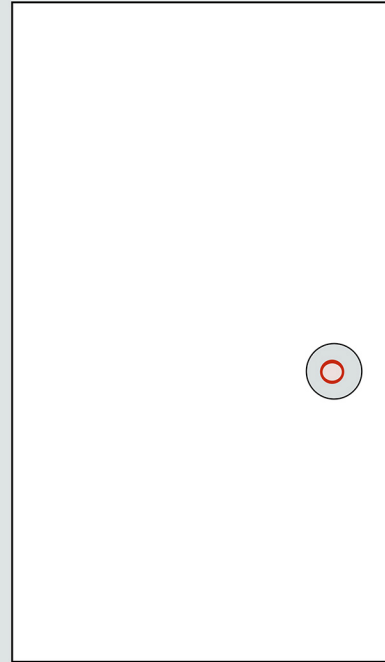
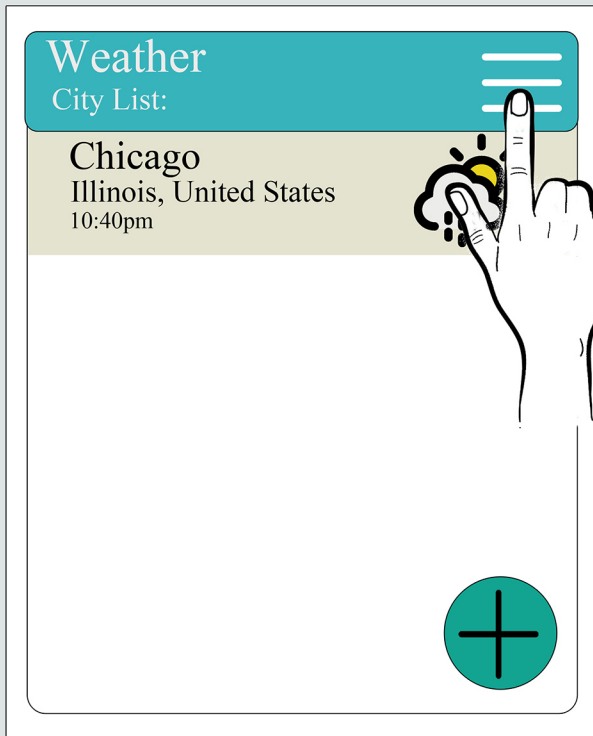

- User wants to change something in options
- User taps the three lines to access options

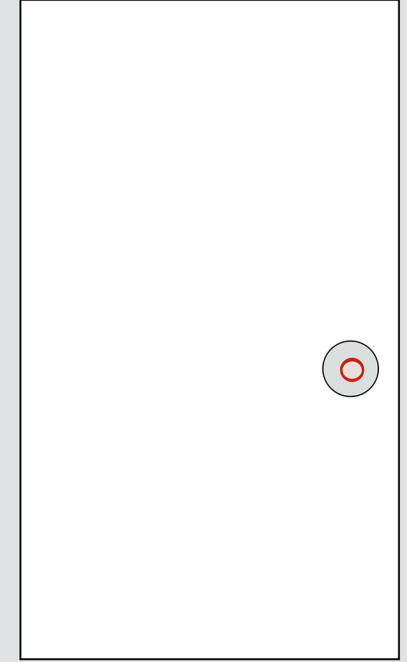
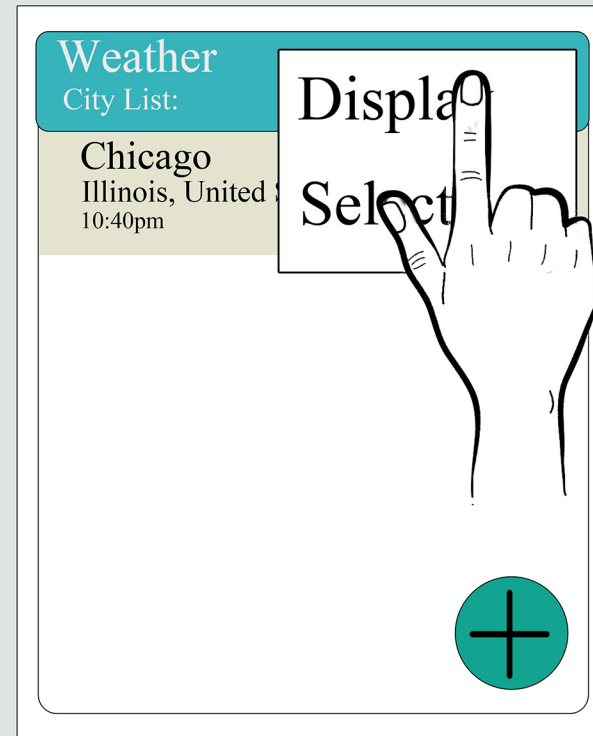

- Options display a list of options to choose from
- User is given display or select

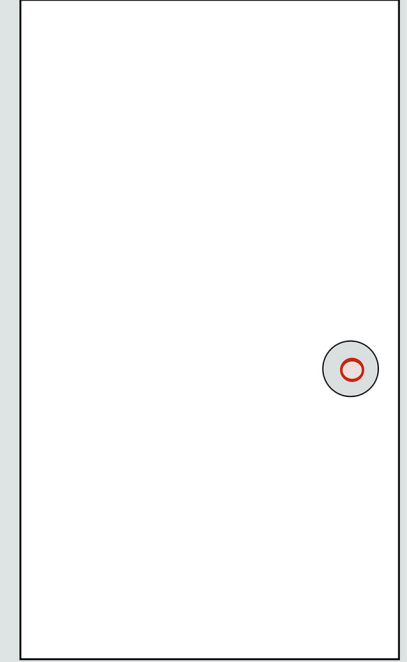
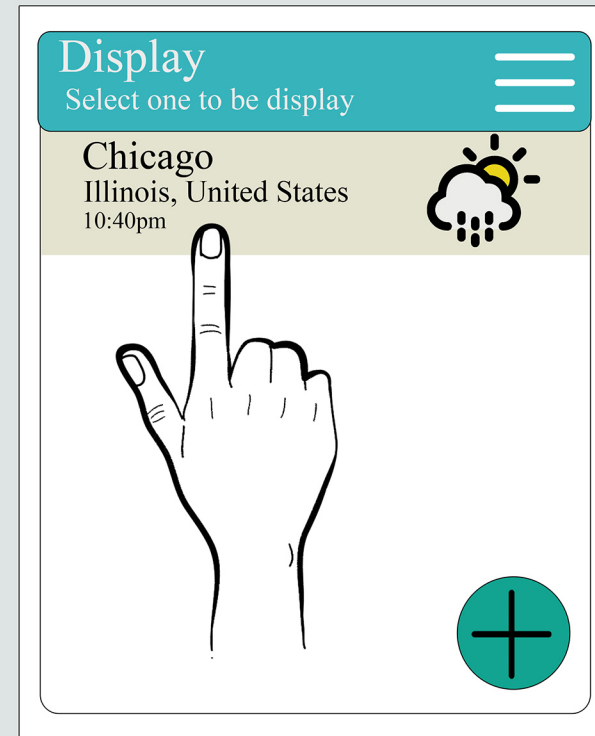
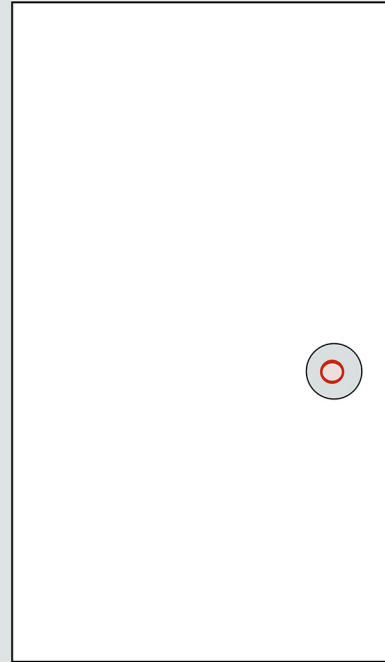
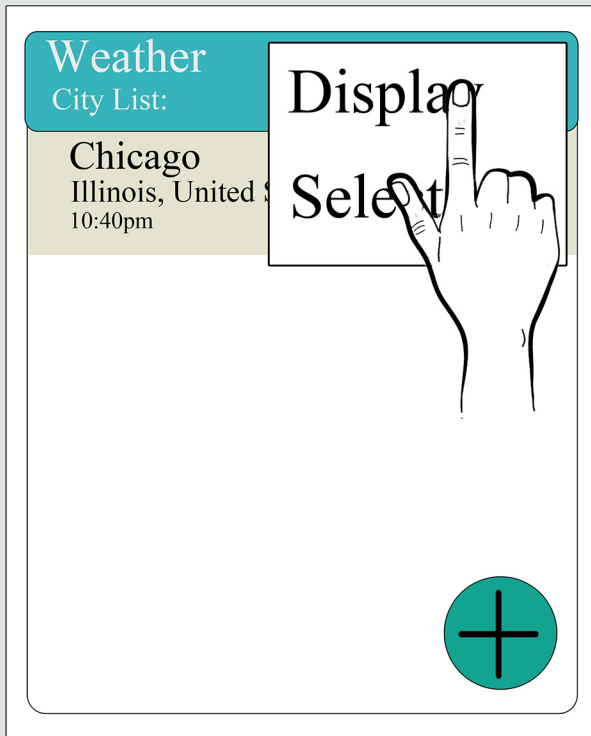

- User wants to select the location to be display
- In the options menu they select display

- The app prompts them message telling to choose location to be display.

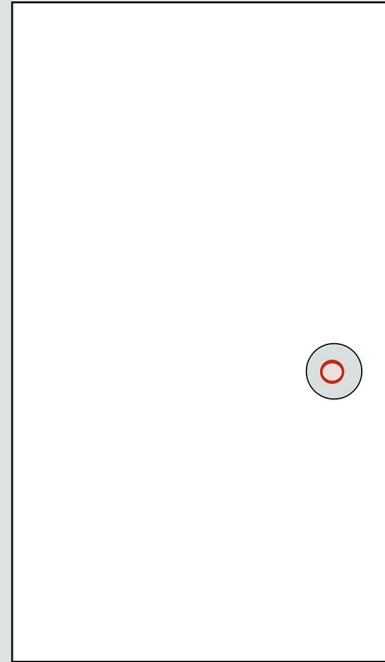

- User want set location as the default location to show on the door for weather
- User taps on a location
- Option is initial tan

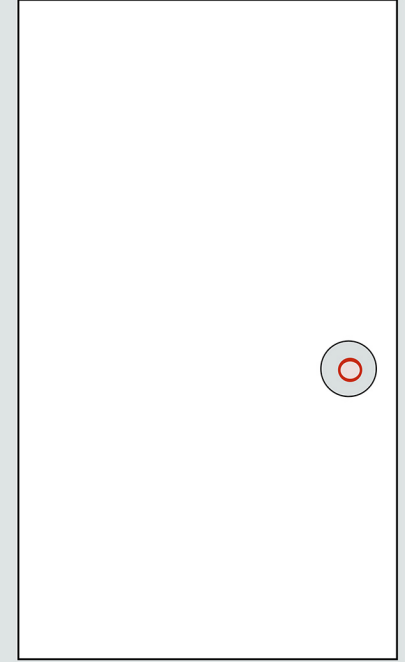
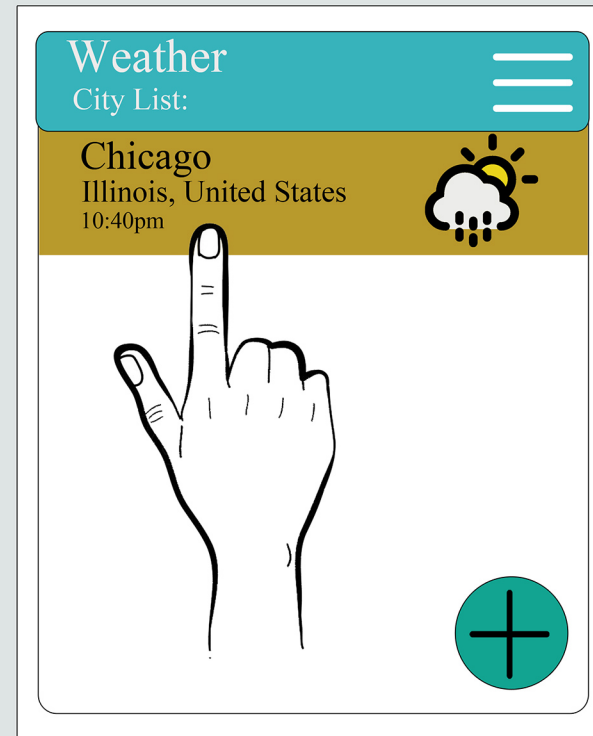

- User taps on location and it color changes from tan to mustard yellow
- This shows that default location has changed



- User wants to access the camera app
- User taps on the camera

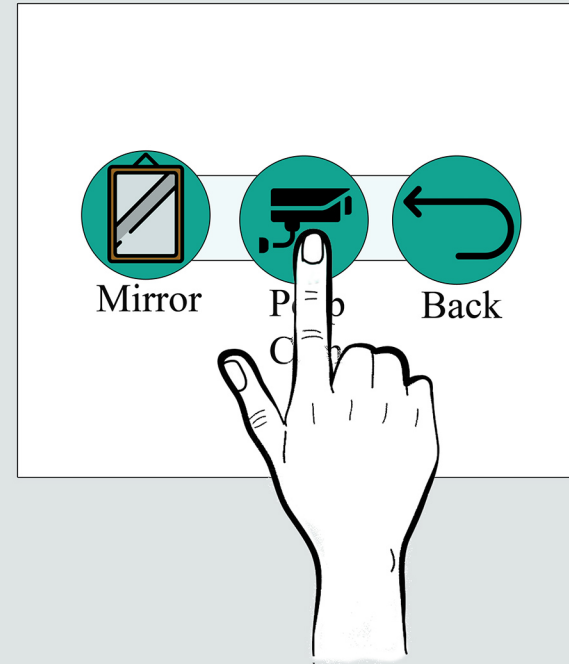
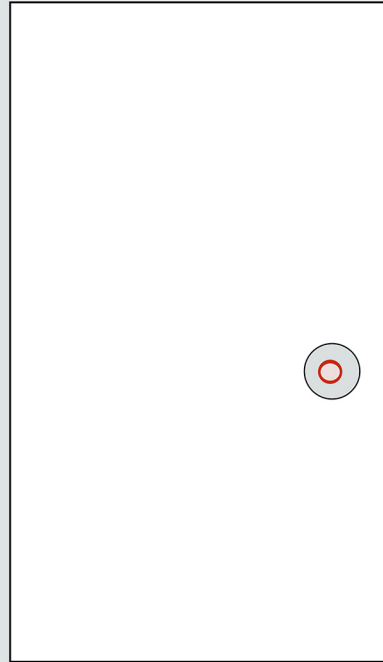

- Camera app gives the user couple of options to choose
- Menu is movable on door
- Initial states are blue

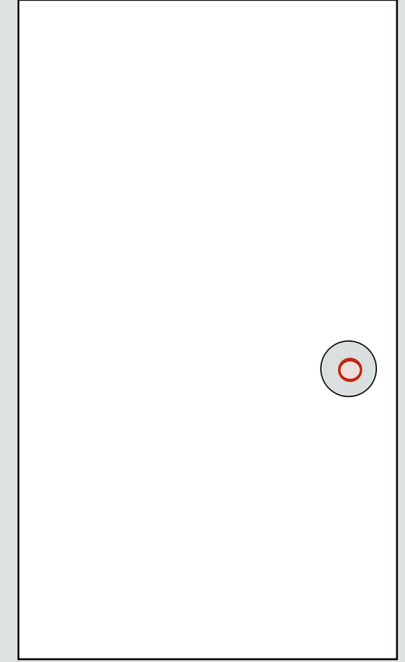

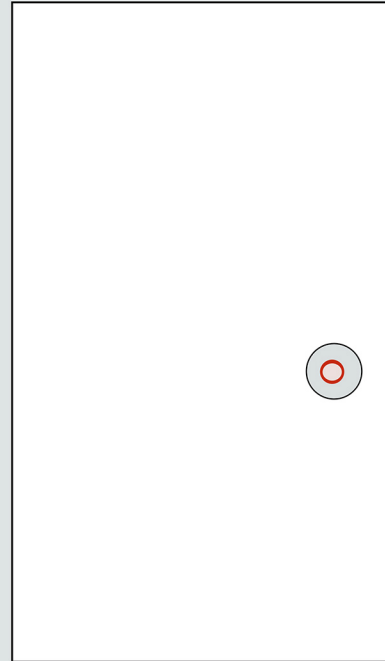
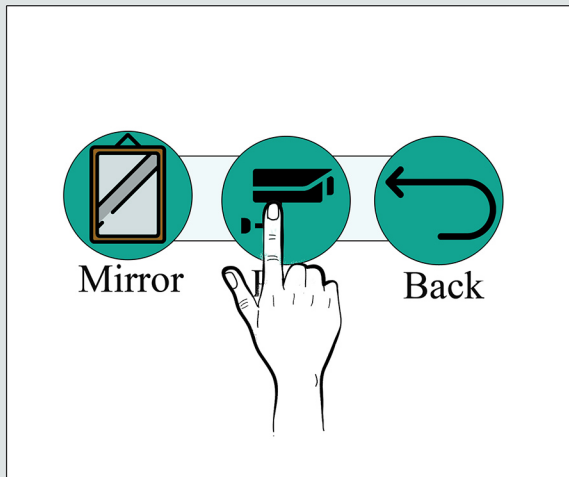

- User wants to look outside
- User taps the camera icon

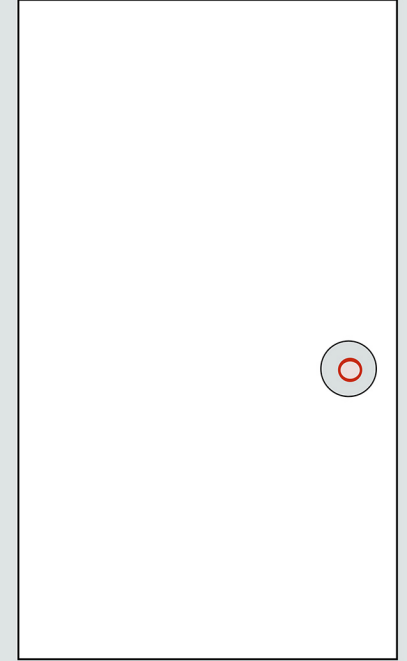
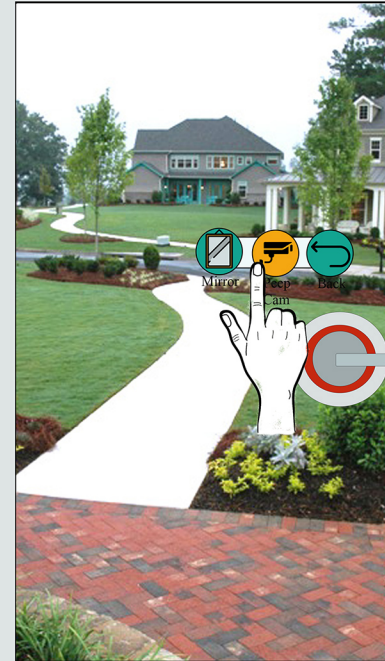

- Camera icon changes from blue to orange
- Menu is moveable
- User can see everything outside of their door

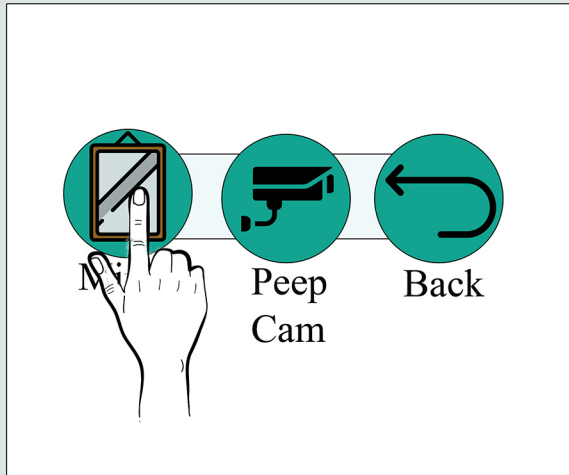

-User wants to see themselves in the mirror

-User taps mirror button

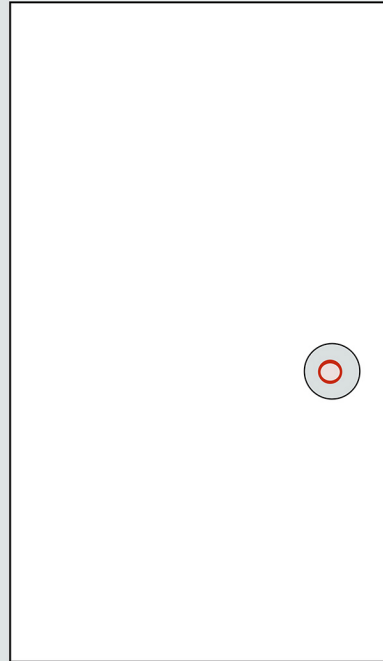

-Mirror button changes color from blue to orange

-Menu is moveable

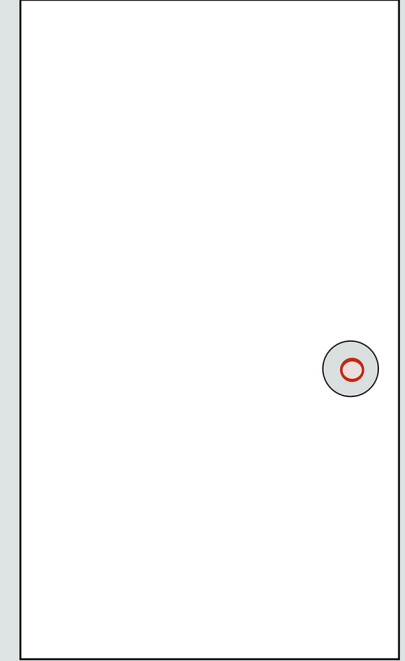

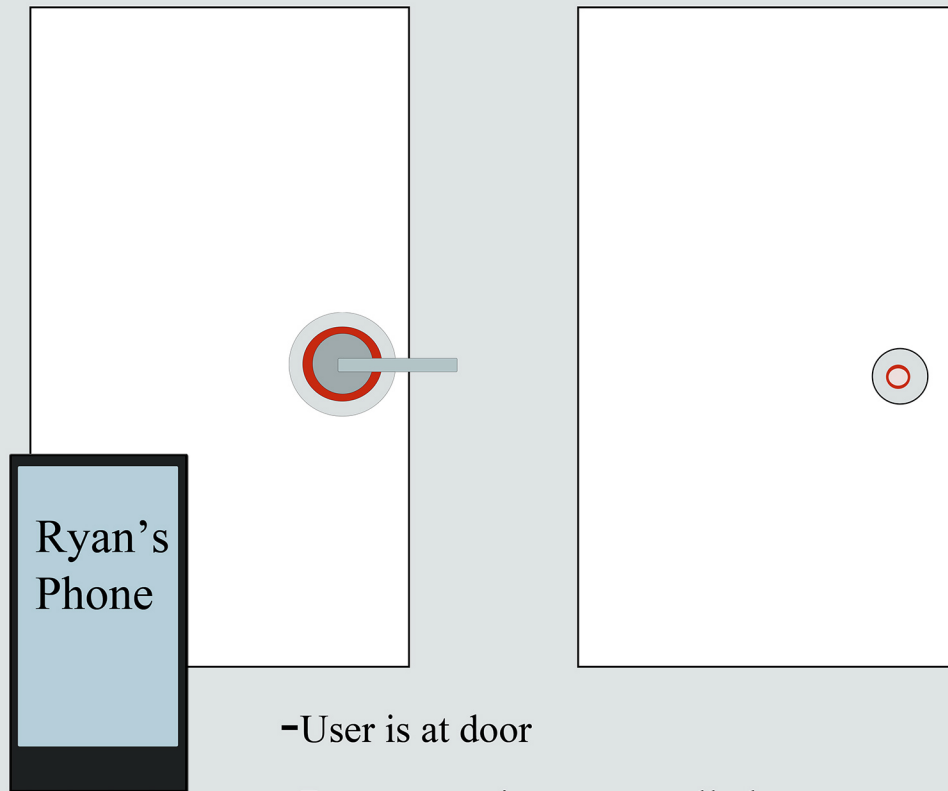

- User is at door
- Door recognizes users cell phone

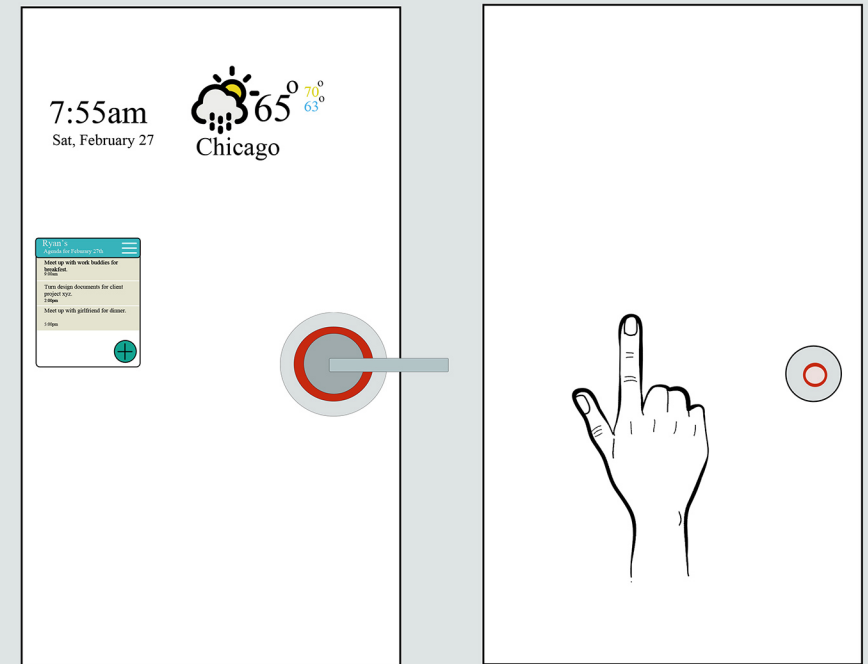

- The door displays the users preset apps
- User name will be display over an preset app if can not be shared



- User wants to access the security alarm for the house
- User taps the alarm button

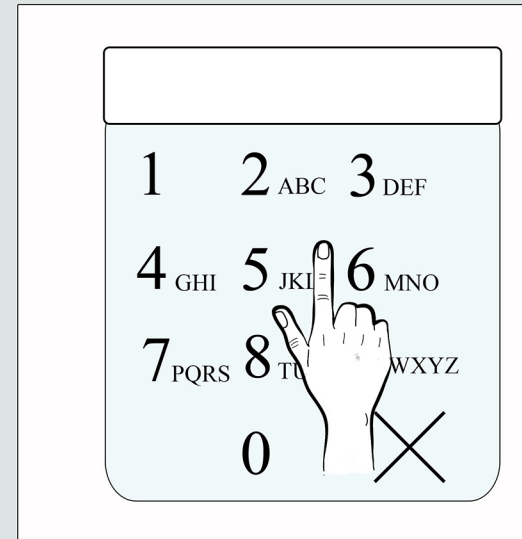
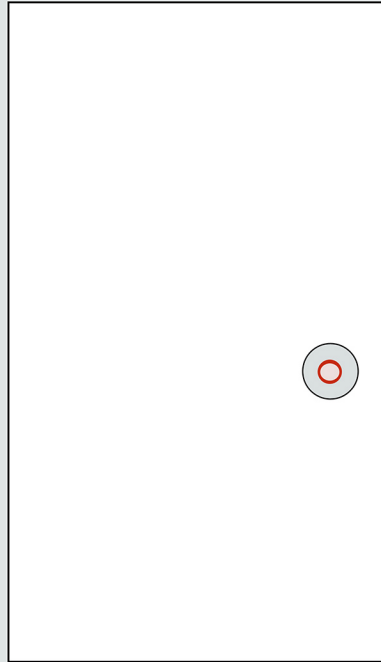

- User see a pad to enter in a button to access the alarm

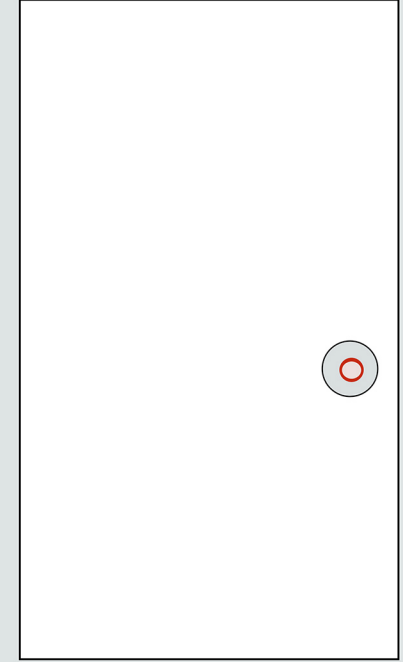

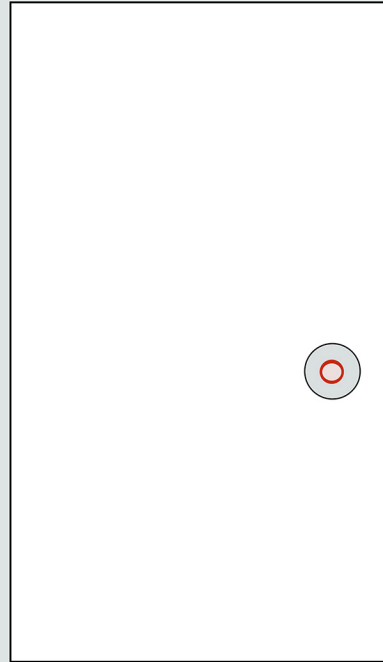
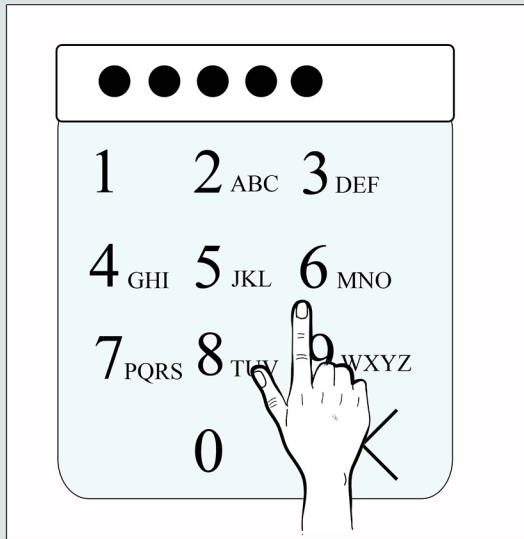

- User enters in pin for alarm
- After enter the 5th pin it either go to the next screen or tell the user they entered in the wrong pin.

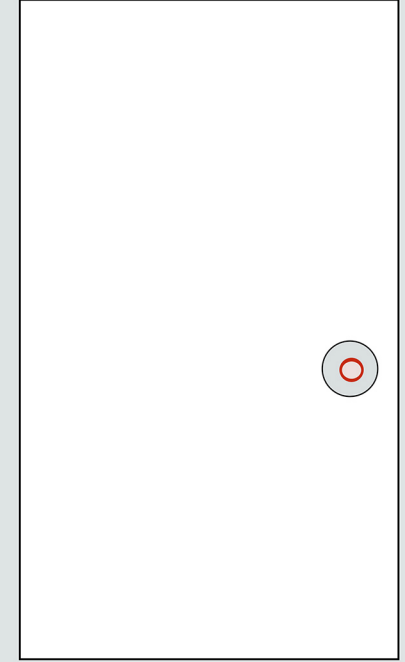
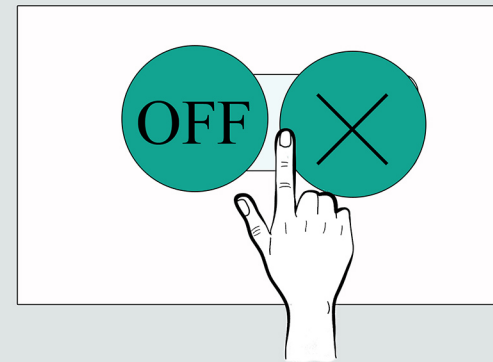

- User is display two options the button to turn the alarm on/off or the exit button
- Tapping the off button turns the alarm off
- Tapping the exit button send the user back to quick access menu

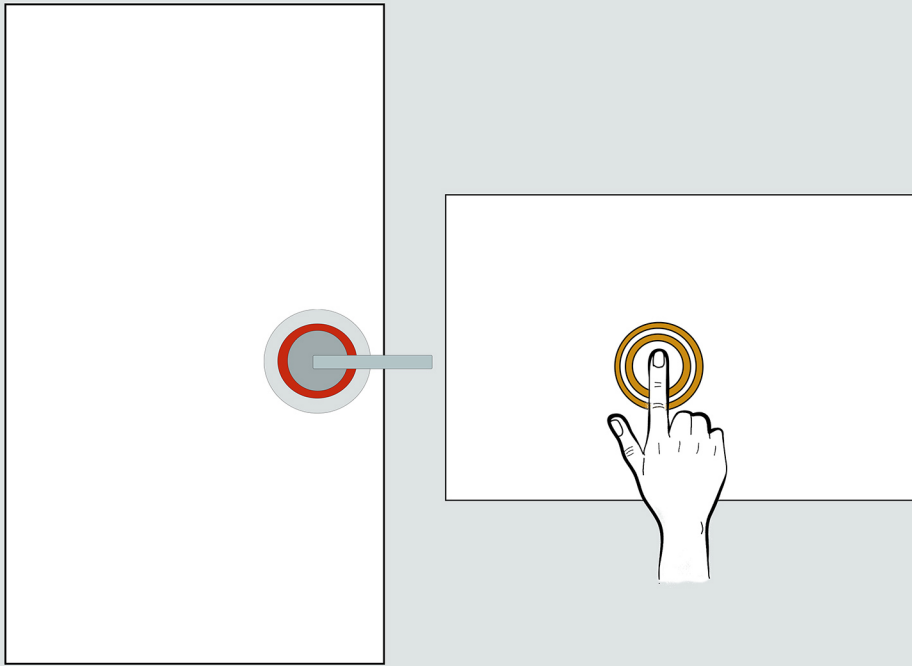

- Outside user wants to make a note
- Outside user would have to tap anywhere on the door

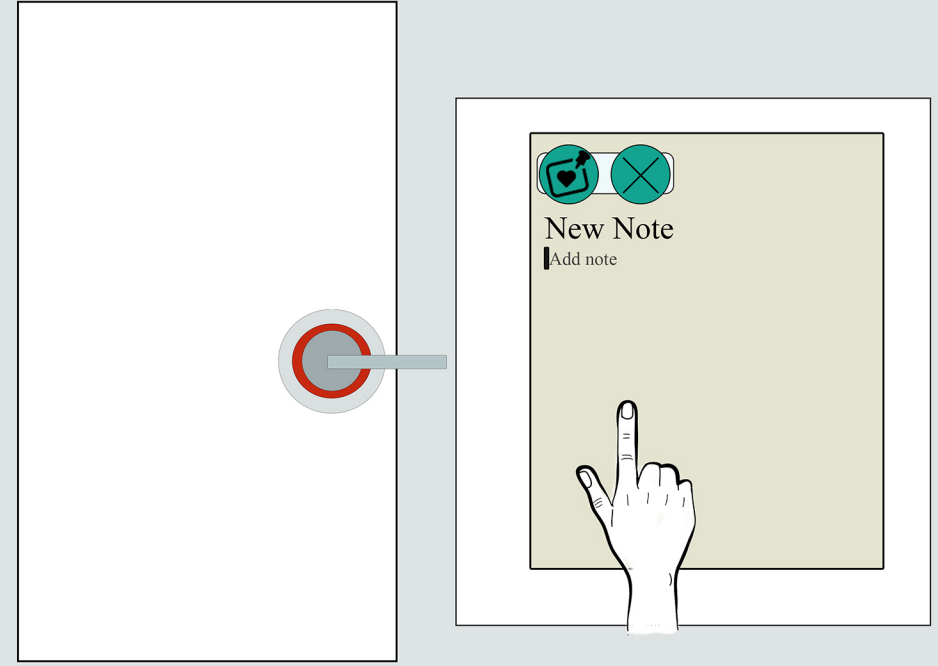

- Once tap a note pad will popup where they tapped
- They can start writing with the onscreen keyboard or through app from their phone

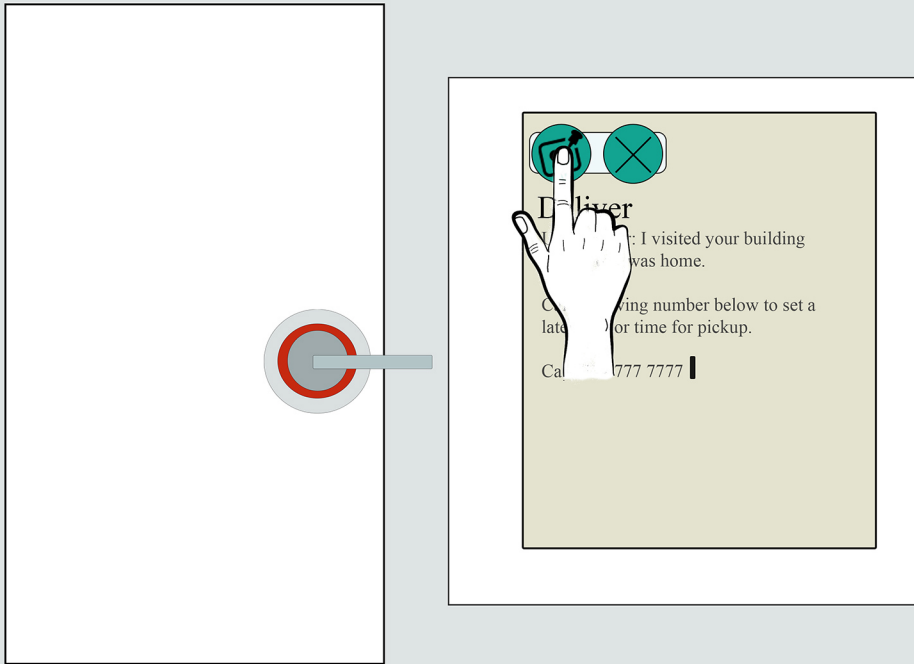

- Once user has finish typing message they can delete it or post it
- When the user hit the post button it will post it on the door

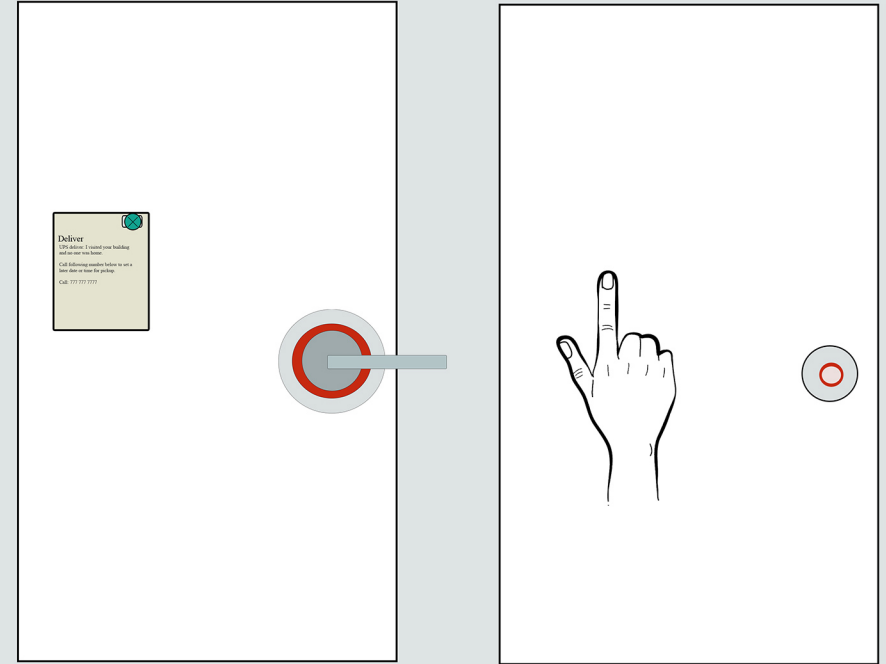

- The message will appear on the other side of the door
- A user on the other side can either save or delete the message

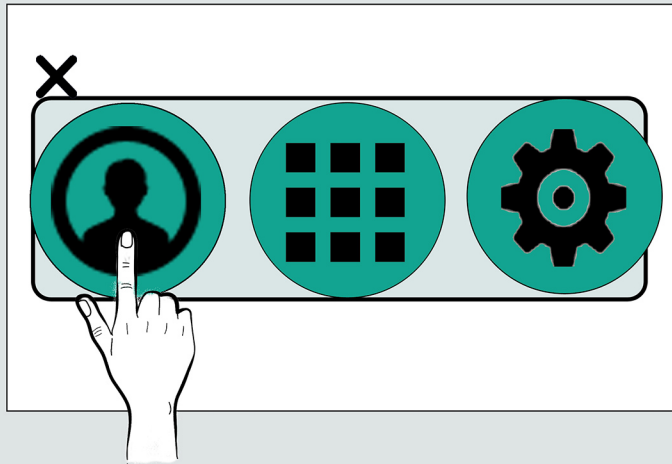

- User wants to access their profile
- User clicks on the profile button

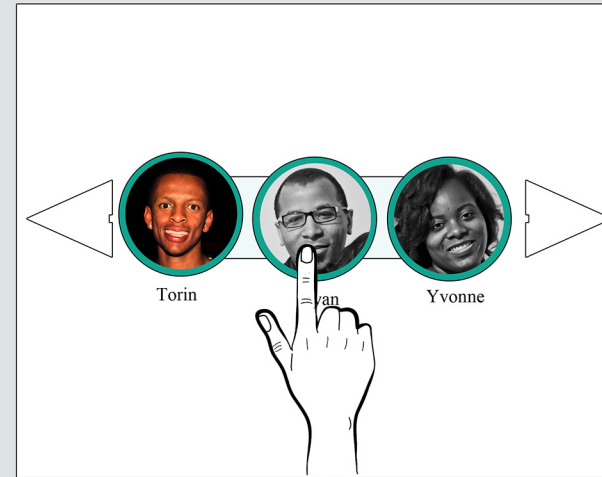
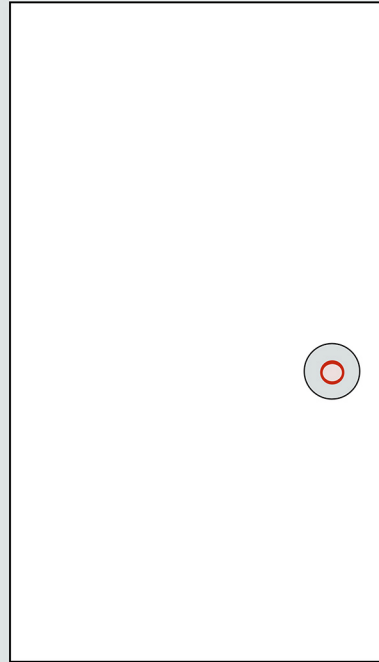

- The door will display list of profile
- User can cycle through list and select their profile.

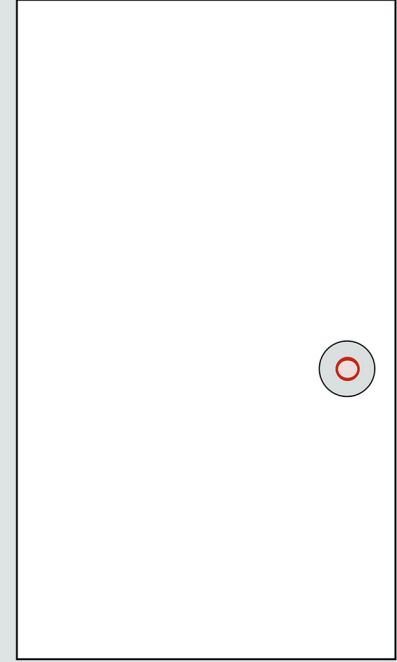

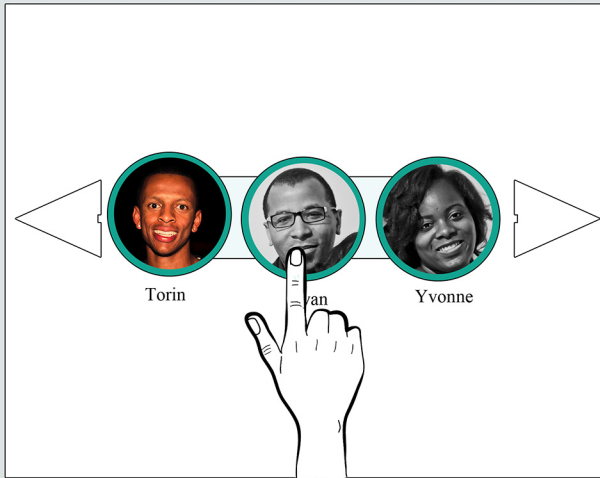

- User wants to access their profile
- User taps on their icon

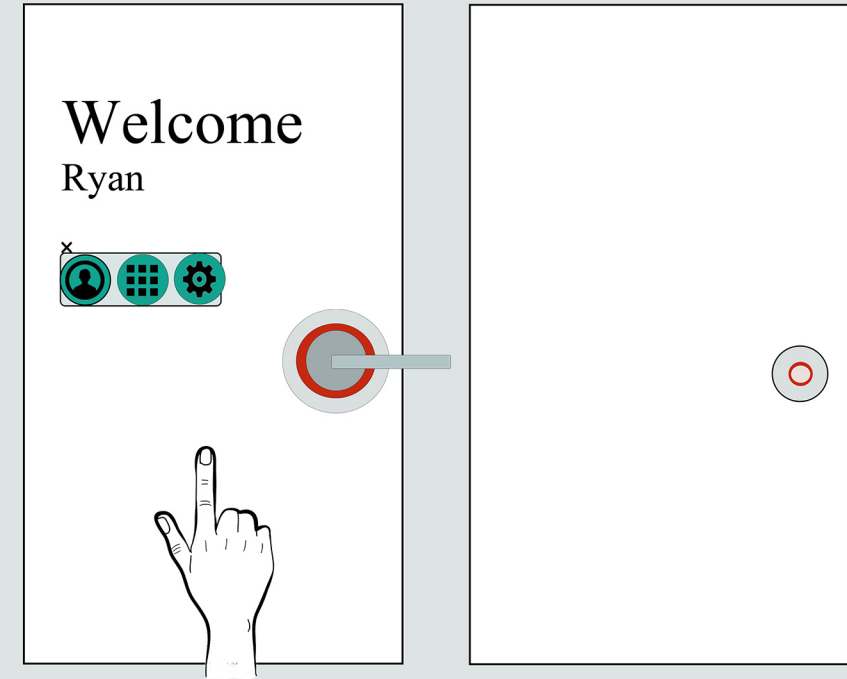
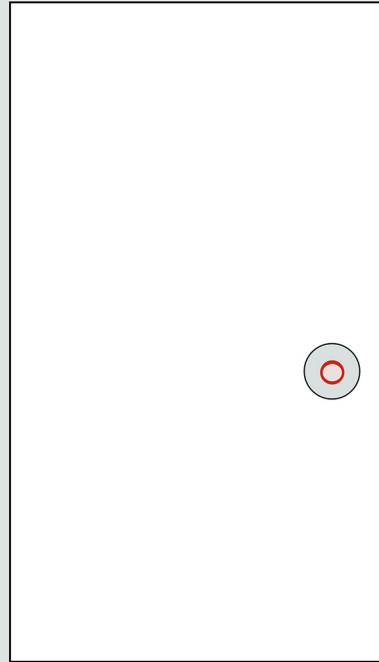

- Door greets user and displays the menu
- User can change door setting according to them

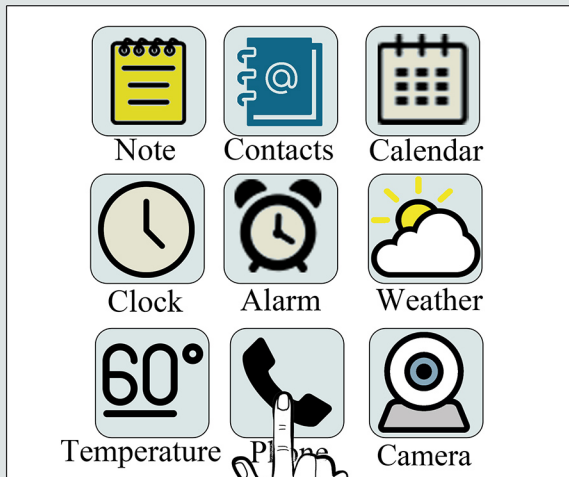

-User taps on the phone app

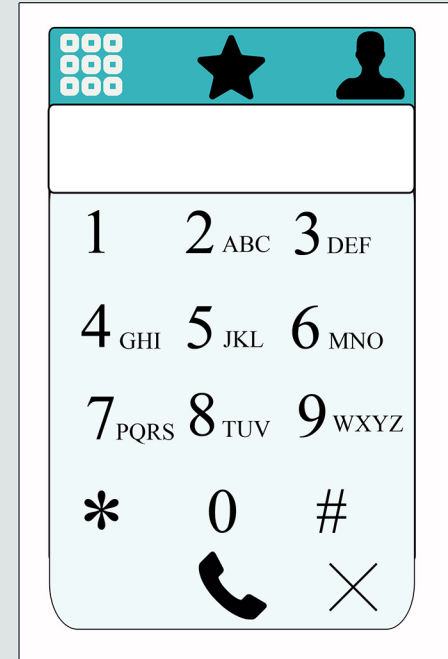
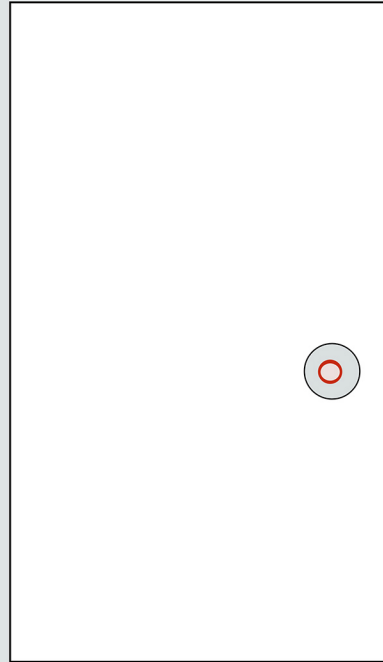

-The phone app will display initial with a dialer
-User than can choose to move to favorite or contacts

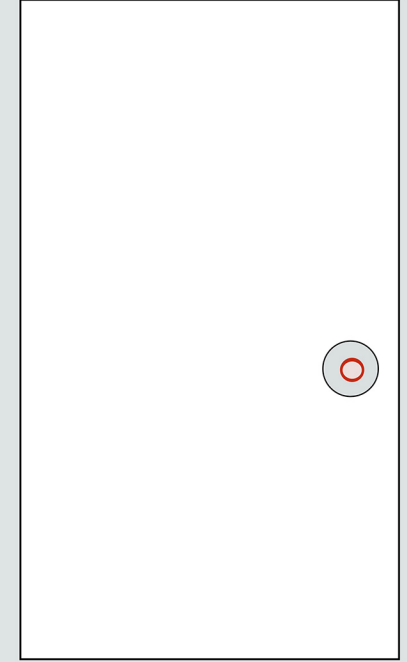

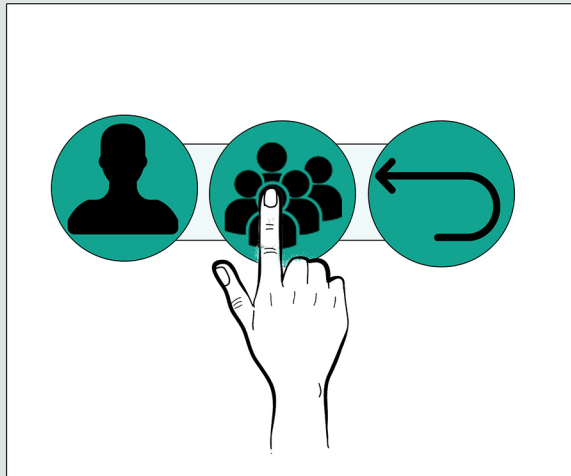

-User select note to be public

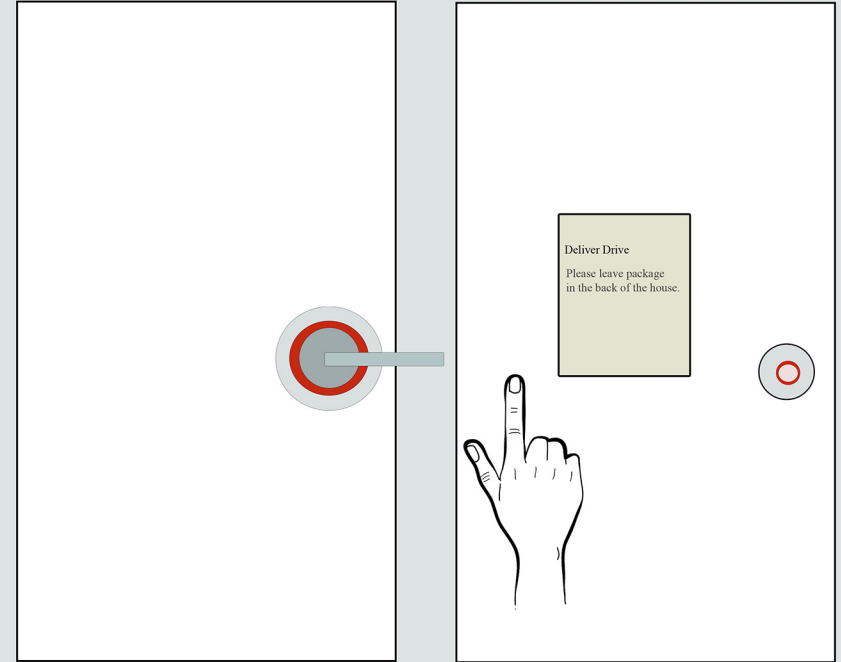
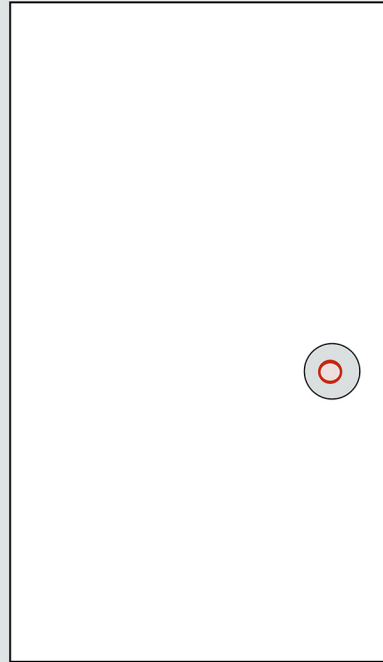

-Note will be appear on the door
for anyone passing by to see

-Note only be removed by an authorized
user

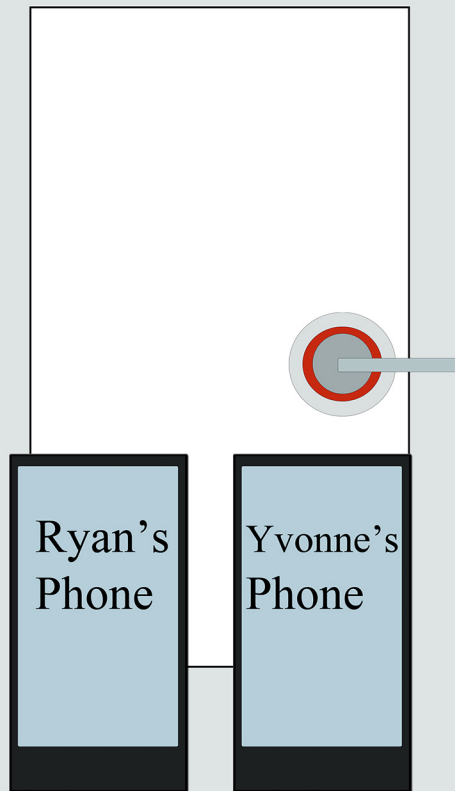

-Door recognizes two different users

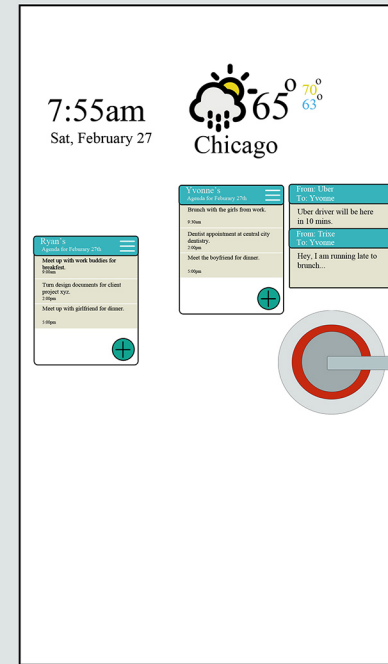
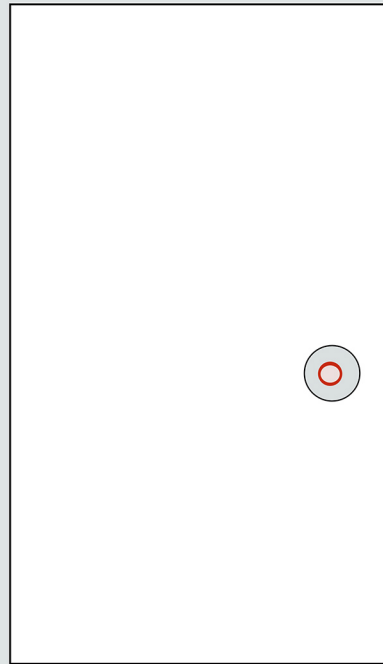

- Door will display individual user presets
- If those users share similar preset that are common than it will display one
- It will display the preset with that user name

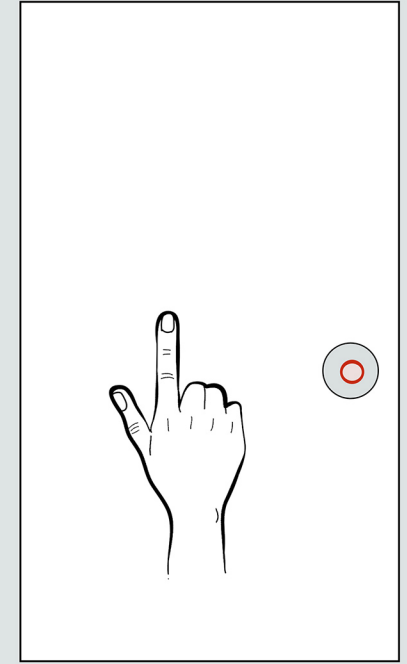

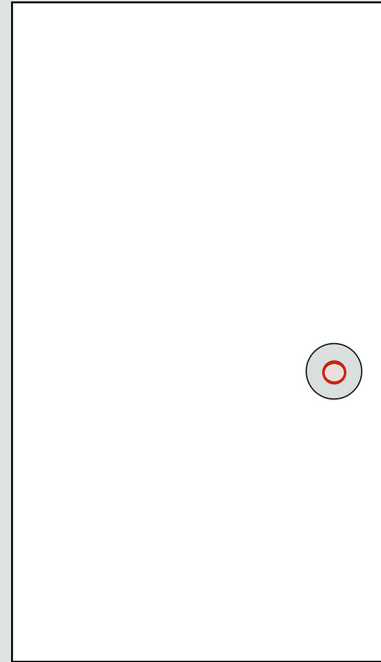
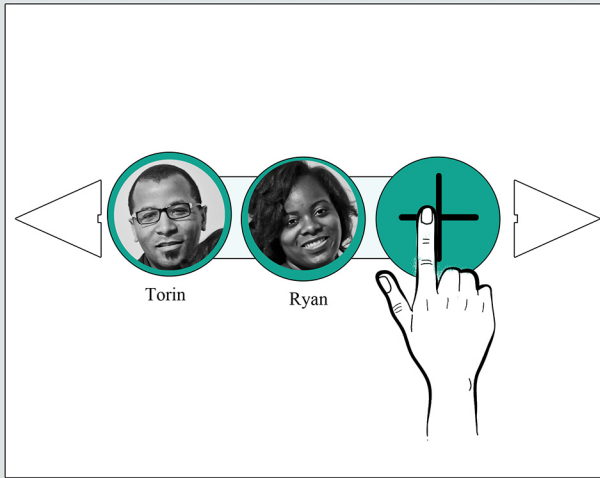

- Unknown user want add a profile
- User taps on the add profile button

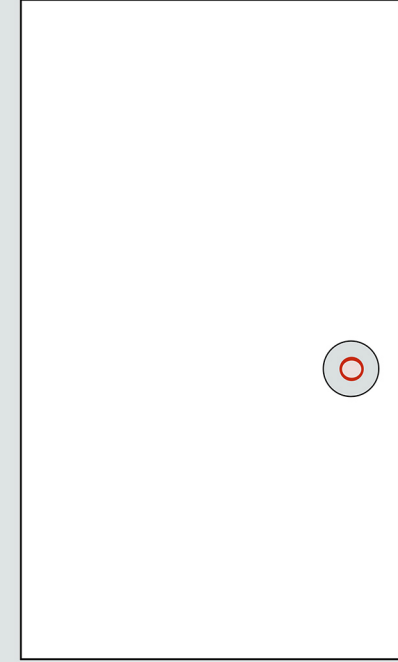

- User is shown a form to fill out
- User can add picture but it required for them fill out the other information in the form

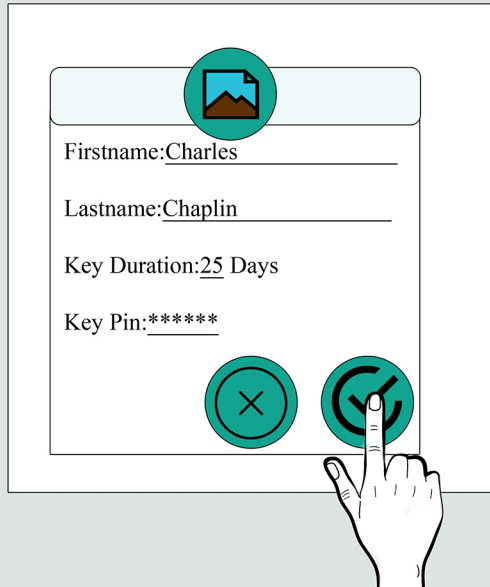

Firstname: Charles

Lastname: Chaplin

Key Duration: 25 Days

Key Pin: *****

Buttons: [Cancel] [Accept]

- User has finish filling out their profile
- User hits the accept button

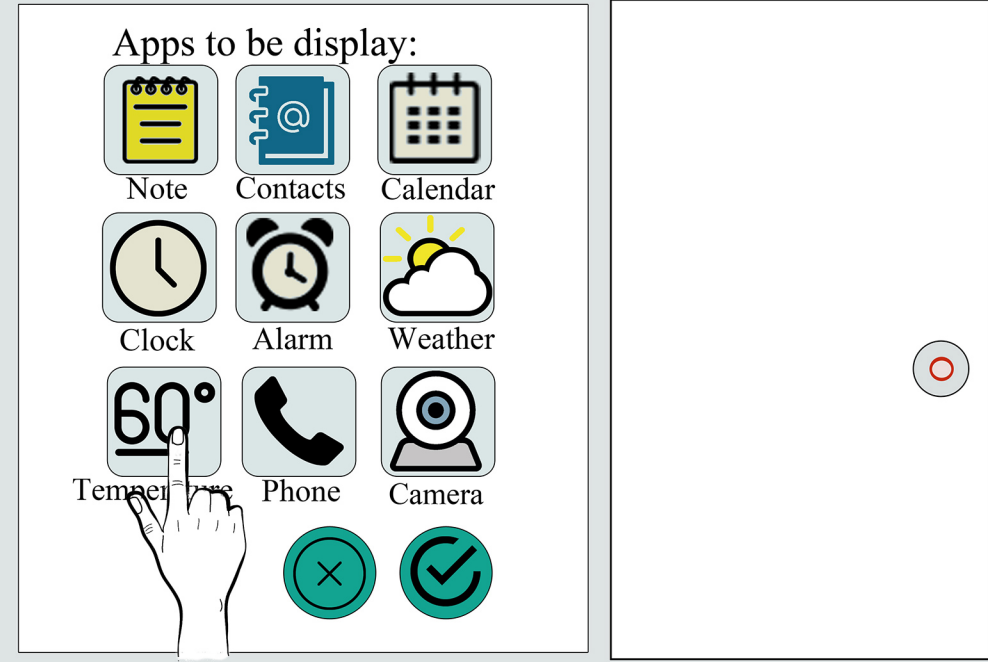
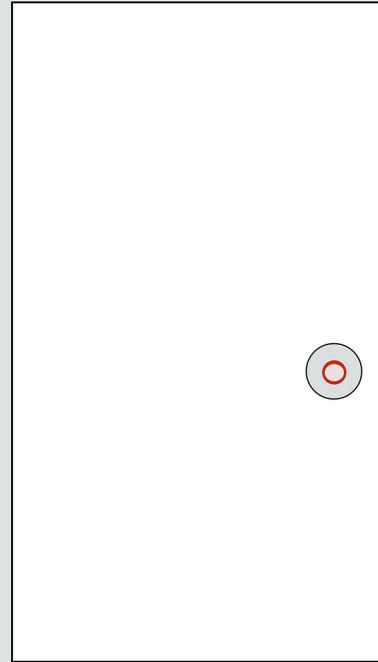

- User is then show a screen to pick their preset
- These preset will be display on the door when the user is near by